



**morton.**

**Woolloomooloo** 451/6 Cowper Wharf Roadway



Fully furnished studio in the unique heritage listed Finger Wharf at Woolloomooloo. East facing views capture the morning sunlight and emphasise the essence of waterfront living through the floor to ceiling glass sliding doors.

- Water views towards Potts Point and Garden Island
- Open plan studio living
- Galley style gas kitchen with granite benchtops
- Built in wardrobes and additional storage
- Internal laundry, 24 hour on site security
- Moments walk to City, Botanic Gardens and Potts Point

**View**

As advertised or by appointment

**Agent**

**Sarah Fowell**



sarah@morton.com.au

**morton.com.au**

# 451/6 Cowper Wharf Road, WOOLLOOMOOLOO

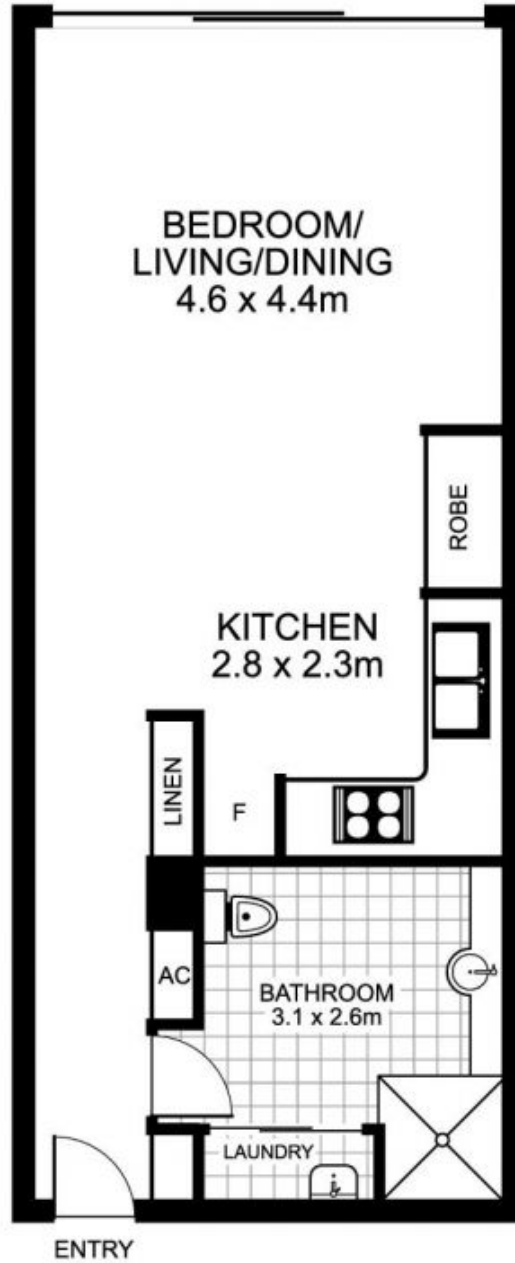

Plans by  
**surroundpix**  
com.au  
1300 30 32 40

This floor plan is intended as a guide only. Layout dimensions are approximate only. No representations or warranties of any nature whatsoever are given or intended. Any person using this information should rely on their own enquiries