



morton.

Elizabeth Bay 11/4 Ward Avenue

1 1

Occupying a desirable north-eastern corner position in a classic Art Deco building, this superb residence offers convenience, comfort and charm in equal measure. Flowing over 57sqm and designed to maximise the flow of light and space, this is a quality opportunity for the first time owner or investor.

- Awash with the light of a coveted northern perspective
- Generous master is complete with pleasant outlook
- Deluxe kitchen, Caesarstone benches, gas appliances
- Refurbished fully tiled bathroom, carpeting throughout
- Facilities include an outdoor pool and common garden
- Bright separate lounge and dining areas, double brick

View

As advertised or by appointment

Agent

Ettiene West

0410 593 749

ettiene@morton.com.au

morton.com.au

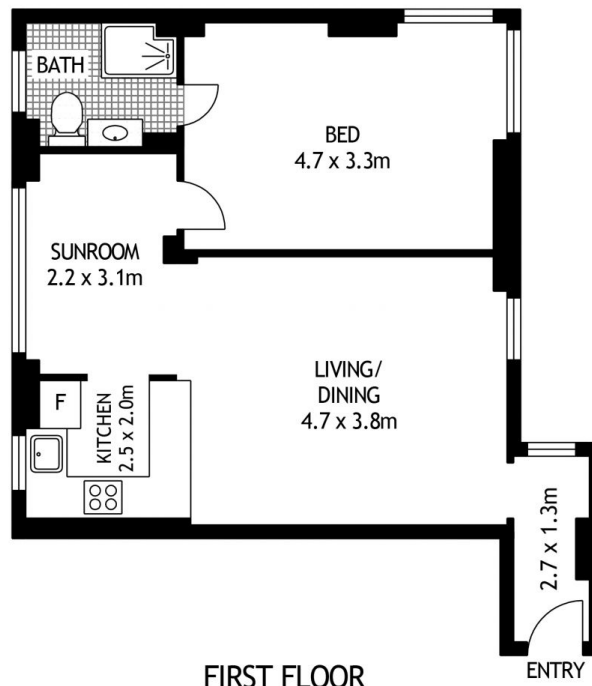

11/4 WARD AVENUE

POTTS POINT

SCAPE Floor Planing Disclaimer: This floor plan is conceptual only, it is provided for illustrative purposes only and should not be relied upon. We make no guarantees to the correctness of this plan. All interested parties should make and rely on their own enquiries in determining the accuracy of the information contained in this floor plan.