



# morton.

**Pyrmont** 6/2-26 Wattle Crescent

1 1 1

This smartly designed ground floor apartment will be very attractive to buyers and investors looking for a quality property with style, privacy and level access to its own private courtyard. Featuring smart modern finishes throughout, it offers a great low maintenance living environment with excellent security and a highly convenient position close to all of Pyrmont's amenities.

- Private ground floor position in the Parkview Towers complex
- A generous 88sqm layout including a private secure courtyard
- Fresh and bright open plan design with easycare tiled flooring
- Thermostat controlled under-floor heating in living areas
- Well-equipped gas kitchen plus a bathroom with full bathtub
- Good-sized double bedroom fitted with a built-in wardrobe
- Air-conditioning, intercom access and secure basement car space
- Indoor swimming pool, spa, sauna, gym and community BBQ area

## View

As advertised or by appointment

## Agents

### Ian Qiu

0447 696 425  
ian@morton.com.au

### Natasha Giannone

0438 683 859  
natasha@morton.com.au

**morton.com.au**

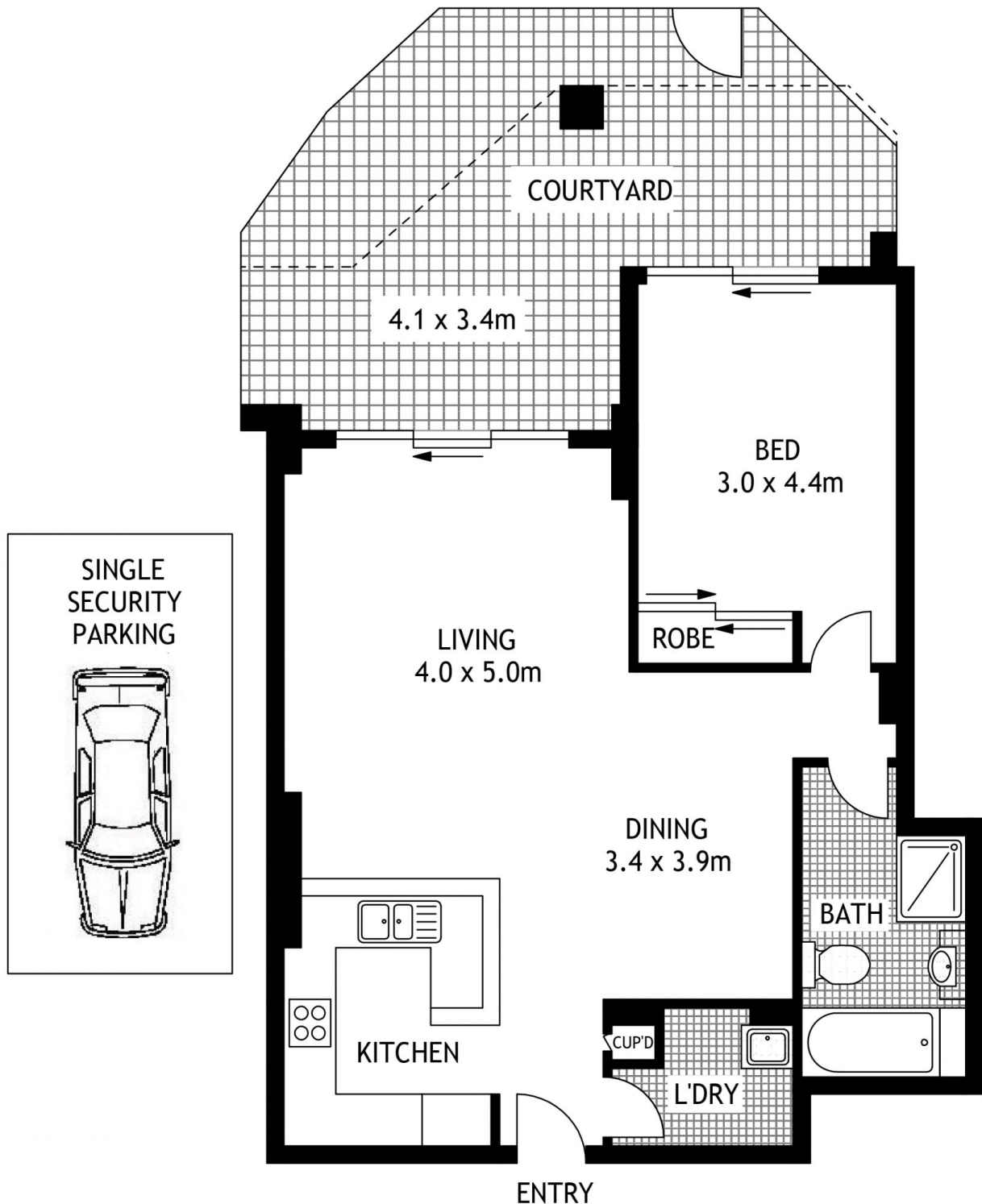

## GROUND LEVEL

6/2-26 WATTLE CRESCENT

PYRMONT

SCAPE Floor Planning Disclaimer: This floor plan is conceptual only. It is provided for illustrative purposes only and should not be relied upon. We make no guarantees to the correctness of this plan. All interested parties should make and rely on their own enquiries in determining the accuracy of the information contained in this floor plan.