



# morton.

**Pyrmont** 23/1 Murray Street

 3  2  2

Single level luxury defines this superb residence where designer style, space and mesmerising views combine to create a stunning lifestyle apartment. Set in Mirvac's prestige Gateway complex, it offers a home of outstanding quality with spacious proportions and breathtaking harbour and city panoramas from every room. This deluxe property showcases a flowing light-filled layout and enjoys a premier location on the doorstep of Darling Harbour, Star Casino, Barangaroo and Sydney's CBD.

- Prime north-east corner position with inspiring northerly vistas
- An expansive layout with over 180sqm indoor/outdoor living space
- Large walls of glass that maximise natural light and city views
- A seamless integration with a wide terrace for entertaining
- Three bedrooms include a separate master wing with ensuite
- Sleek and modern kitchen fitted with sleek Miele appliances
- Ducted air-conditioning, two security car spaces and lock-up

### **View**

As advertised or by appointment

### **Agent**

**James Crow**

 0410 593 057

 james@morton.com.au

[morton.com.au](http://morton.com.au)

Apartment 23/1  
Murray St

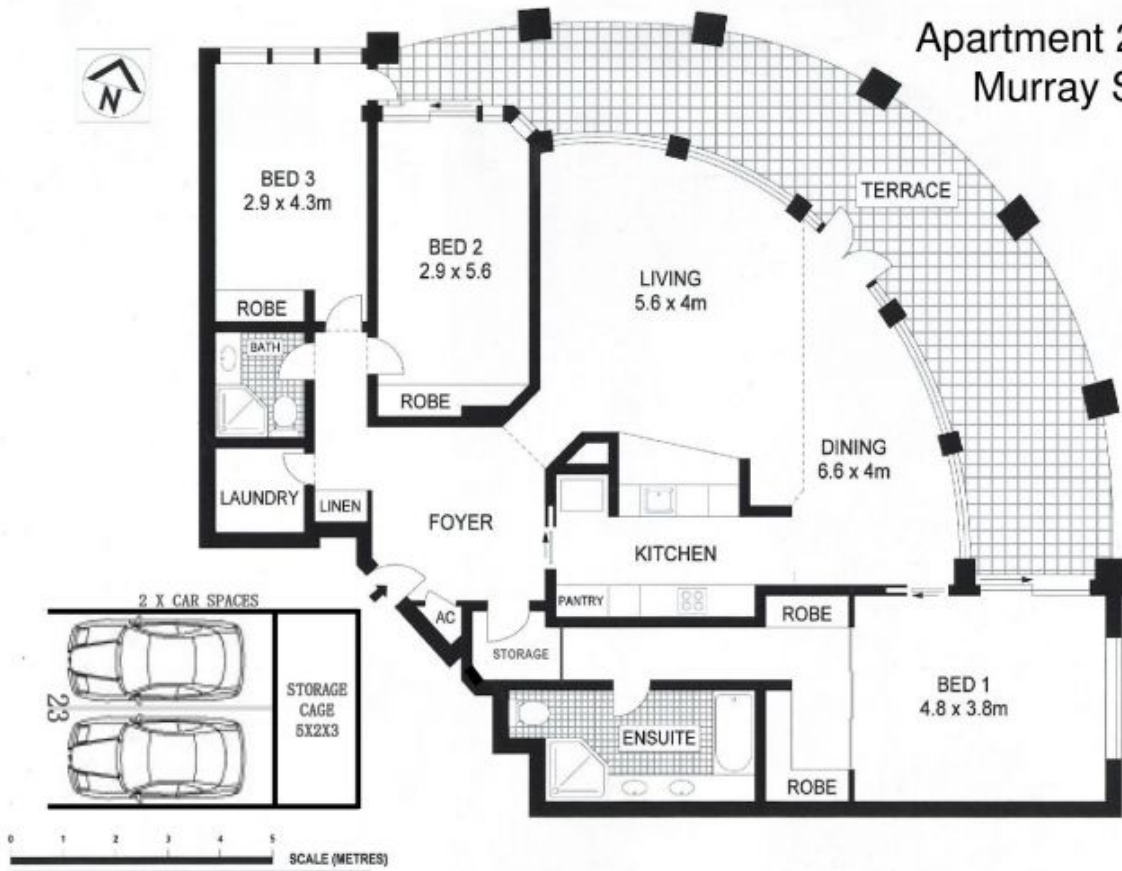

PLANS SHOWN ONLY INDICATIVE OF LAYOUT. DIMENSIONS ARE APPROXIMATE.