



morton.

Woolloomooloo 532/6 Cowper Wharf Roadway

1 2 1

This tastefully renovated waterfront loft apartment is located on the top floor boasting a generous 96sqm. Offering the perfect mixture of convenience and luxury this apartment is not one to be missed. State of the art marble bathroom with top quality finishes. Plenty of extra storage has been added for convenience.

- High ceilings and a great sense of space
- Security parking in Lincoln crescent
- Built in cupboards and walk in robe
- Reverse cycle ducted air conditioning
- Large bath in bathroom
- Luxurious finishes including granite bench tops and stainless steel appliances
- Video intercom security 24 hour security on site
- Optional gym and pool membership

View

As advertised or by appointment

Agent

Noel Jenkins

0410 593 694

noel@morton.com.au

morton.com.au

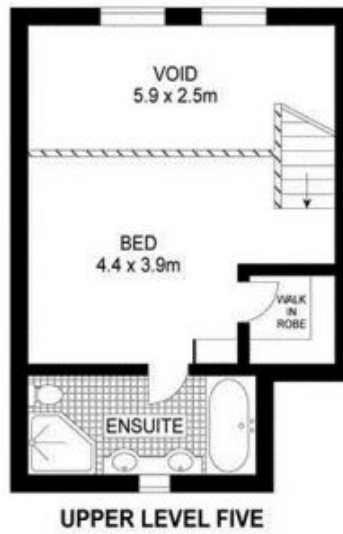

PLANS SHOWN ONLY INDICATIVE OF LAYOUT. DIMENSIONS ARE APPROXIMATE

Disclaimer: Plans shown are for presentation purposes and are not part of any legal document or title and are subject to errors, omissions inaccuracies and should not be used as sole reference. All measurements are approximate. Interested parties should make their own enquires using other sources supplied.



532/6 Cowper Wharf roadway Woolloomooloo