

morton.

Sylvania 90 Edward Street



This beautiful home is located in a quiet neighbourhood and prominently set on the high side of one of the area's most desirable streets in Sylvania. Surrounded by a tranquil leafy setting and garden, enjoy gorgeous sunsets from your front porch all year round.

- Spacious living rooms with air-conditioning
- Open plan kitchen with ample storage
- Large light filled bedrooms all with built-in robes
- Lounge opens out to covered entertaining area
- Modern bathroom with feature clawfoot bath
- Entertainers yard and undercover carport
- Additional secure storage underneath house
- 450sqm land size and 384sqm on title
- Fantastic location close to shops, schools, transport and Miranda Westfield

View

As advertised or by appointment

Agent

Sarah Fowell

📞 0437 492 129

✉️ sarah@morton.com.au

morton.com.au



The interior style and design of this floor plan is designed for inspiration purposes to show the living spaces. It is not an exact replica of the furniture and fittings in the home.

Produced by DIAKRIT

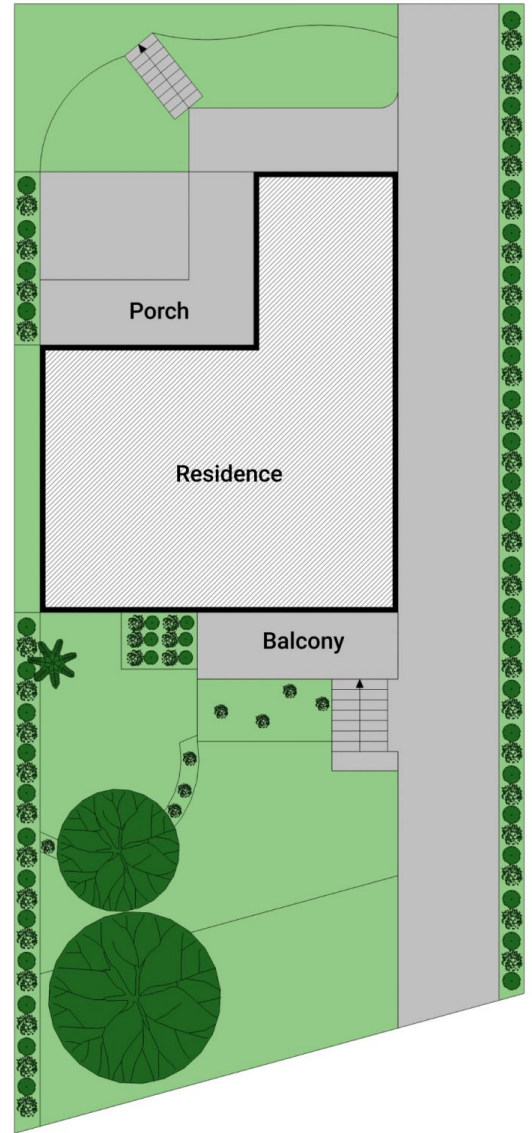
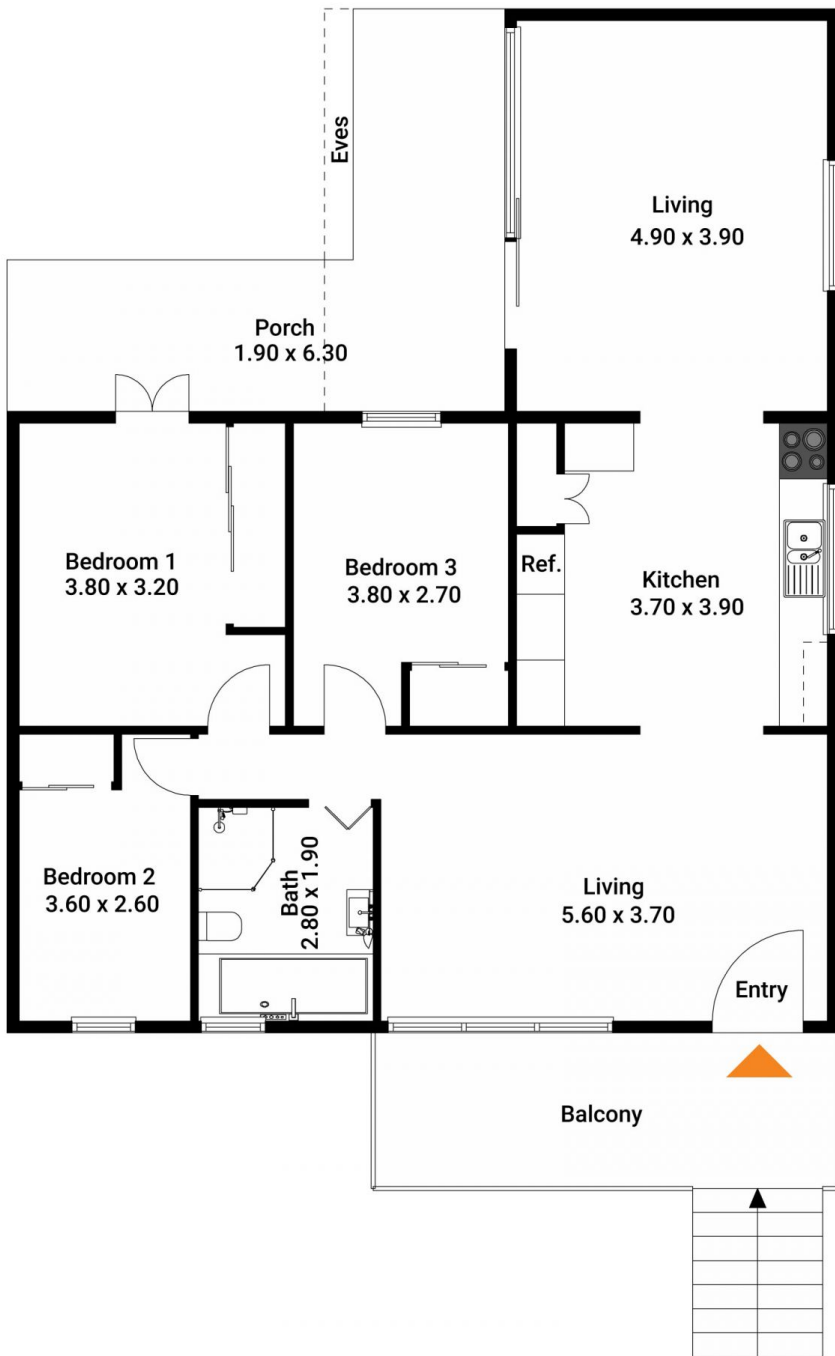

Siteplan

The floor plan is not to scale. Measurements are indicative and in metres.

Produced by DIAKRIT