



morton.

Zetland 541/2C Defries Avenue

 1  1  1

Designed for stylish and convenient living this beautifully presented one bedroom apartment is located within Victoria Park's coveted East Village, enjoying immediate access to a unique sky park and vibrant retail and dining precinct below. Recently built in 2014 by developers PAYCE and designed by Turner + Associates, the apartment blends high quality finishes with functional spaces and is perfect for tenacious investors or owner occupiers.

- 62sqm floor plan highlighted by sleek interior styling
- Peaceful all-weather balcony with metropolitan views
- Large study area/home office
- Open plan lounge and dining with polished tiled floors
- Integrated kitchen with granite bench tops and stainless steel appliances
- Spacious double bedroom with walk-in robe and balcony access
- Deluxe designer bathroom and Internal laundry
- Air-conditioning; Secure intercom entry with lift access
- Single secured car space

morton.com.au

View

As advertised or by appointment

Agent

Sarah Fowell

 0437 492 129

 sarah@morton.com.au

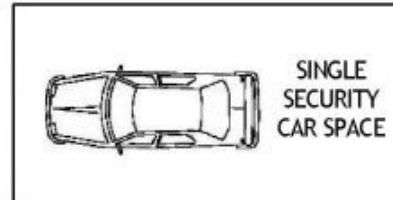
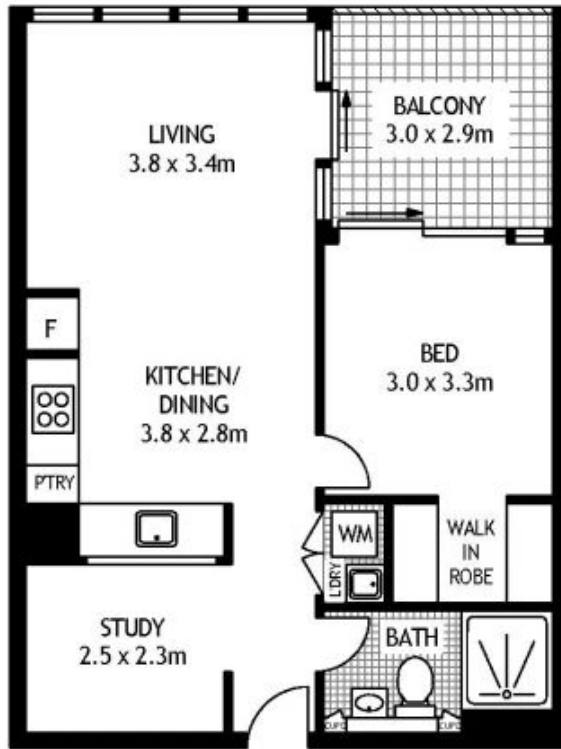

ENTRY

LEVEL FIVE



541/2C DEFRIES AVENUE

ZETLAND

SCAPE Floor Planning Disclaimer: This floor plan is conceptual only. It is provided for illustrative purposes only and should not be relied upon. We make no guarantees to the correctness of this plan. All interested parties should make and rely on their own enquiries in determining the accuracy of the information contained in this floor plan.