



morton.

Ashfield 807/268-270 Liverpool Road

🛏 1 🚿 1 🚗 1

Stunning near new development situated in the heart of Ashfield, this sun drenched apartment occupies a top floor position with expansive district views. Combining sophisticated urban living with superb finishes, stylish and functional design.

- Two skylights offering an abundance of natural light
- Large designer bedroom including built-in wardrobe
- Open plan living/dining area with oak timber floor boards
- High quality finishes with great outlook
- Large multi-purpose room/study
- High quality reconstituted stone kitchen bench top
- Stainless steel cooktop, oven and dishwasher
- Modern bathroom, internal laundry
- Ducted air conditioning throughout
- Secure car space and storage cage

View

As advertised or by appointment

Agent

Sarah Fowell

📞 0437 492 129

✉ sarah@morton.com.au

morton.com.au



The interior style and design of this floor plan is designed for inspiration purposes to show the living spaces. It is not an exact replica of the furniture and fittings in the home.

Produced by **DIAKRIT**

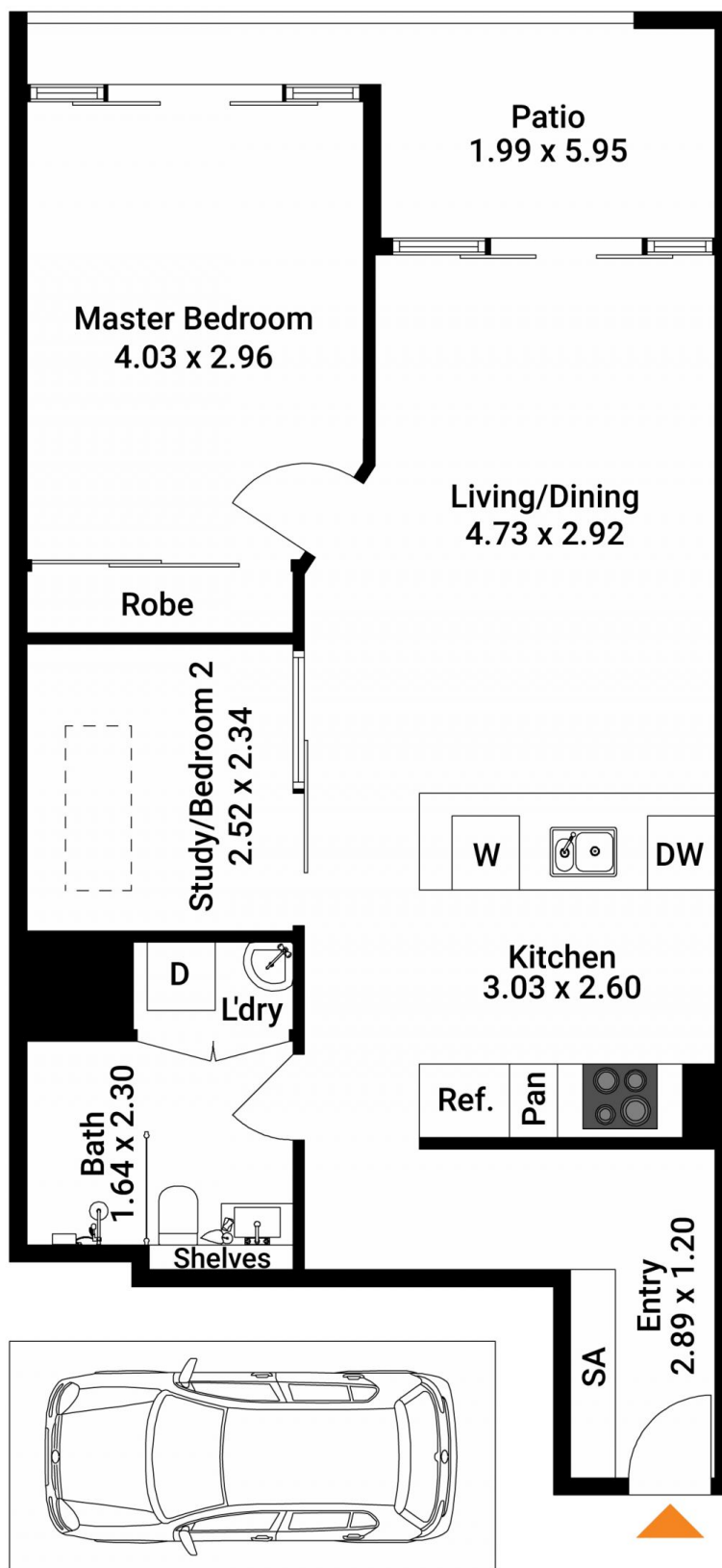

Standard Car Space
(Not In Position)

Total Living Area : 64 SQM

The floor plan is not to scale. Measurements are indicative and in metres.

Produced by DIAKRIT