



morton.

Sydney 904/35 Shelley Street

 3  3  2

Occupying a truly magnificent setting in a blue ribbon harbourside enclave, this flawless residence is an offering unmatched in style or aspect. Intuitively designed for effortless modern living and filled with natural light, panoramic views stretch across Darling Harbour, Pyrmont, Balmain, and the lower north shore.

- Impressively well proportioned open plan lounge/dining
- Double bedrooms with views, master/2nd with ensuites
- Italian inspired designer kitchen with Miele appliances
- Generous entertainers balcony, private and peaceful
- Deluxe bathrooms, LED lighting and bespoke cabinetry
- Ducted air, American Oak timber floors, pool and gym
- Just a walk to Wynyard, ferries, theatres and parklands
- Renovated and modern finishes throughout

View

As advertised or by appointment

Agent

Ettiene West

 0410 593 749

 ettiene@morton.com.au

morton.com.au

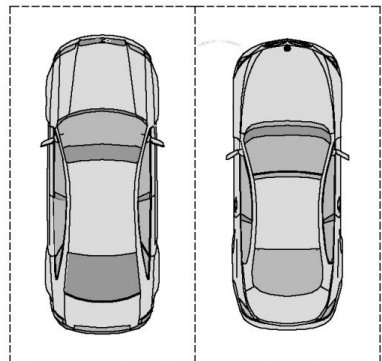
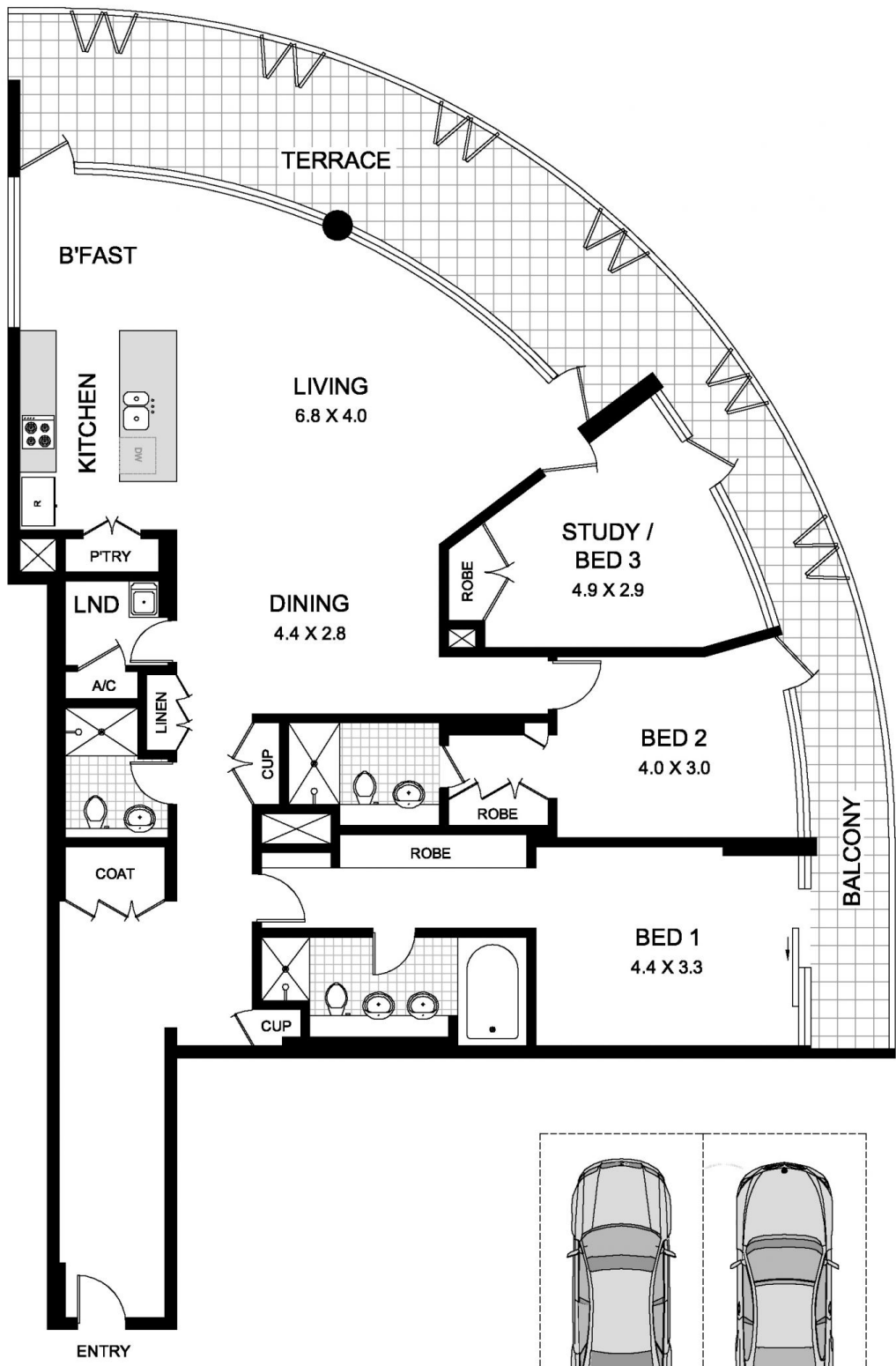

SECURITY CARSPACES

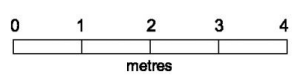

This plan is for illustrative purposes only and dimensions are approximate. It does not constitute part of any legal document or commercial contract for the sale or lease of this property.

 METRO FLOORPLANS
0418 223 433

**S904/35 SHELLEY STREET
SYDNEY**