



morton.

Wentworth Point 101/4 Nuvolari Place

 1
  1
  1

Flooded with northern light and opening to expansive courtyard, this superb residence is peacefully set in the heart of Wentworth Point. Designed for a low maintenance contemporary lifestyle of convenience and distinction, it is approximately a ten minute walk to Rhodes Station.

- Impeccably presented interiors, quality appointments
- Stunning communal gardens, facilities include pool and gym
- Combined lounge and dining flows to a huge courtyard
- Stylish kitchen, CaesarStone benches, gas appliances
- Generous master bedroom with built-ins
- Large internal laundry room, storage cage
- Air conditioning and video intercom

View

As advertised or by appointment

Agent

Sarah Fowell

 0437 492 129

 rentals@morton.com.au

morton.com.au



LEVEL 01

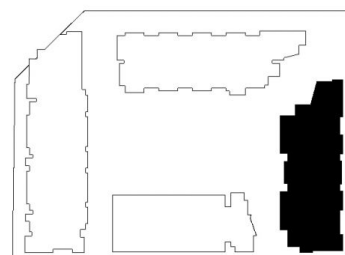

PALERMO

UNIT: **101**

TYPE: 1 Bedroom

UNIT AREA: 61.0 sqm

OUTDOOR AREA: 47.0 sqm



0 2.5 5M