



# morton.

**Penrith** 305/60 Lord Sheffield Circuit

 2  2  1

## View

As advertised or by appointment

## Agent

**David Lipman**

 0409 663 535

 david@morton.com.au

LEASED FOR \$480 PER WEEK. If you are a Landlord looking for a tenant before Christmas, please urgently contact David Lipman, david@morton.com.au, 0409 663 535, so we can help you find a great tenant and look after your property management. Morton are the #1 local leasing and sales agent in Thornton Estate and the #1 leasing agent for units in Penrith.

Wildwood Apartments within Sheffield Quarter is a brand new apartment development located on the north side of Penrith train station situated in the highly sought after master-planned community Thornton Estate. With uninterrupted park and district views, plus water views towards the picturesque Blue Mountains, offering convenient apartment living only metres to Penrith train station, Westfield shopping centre, local parks and quality restaurants and cafes.

- Positioned on the south west corner of the building with a distinctive exterior façade overlooking the water canal and the cricket oval, these are some of the best views you will find in

**morton.com.au**



# SHEFFIELD QUARTER

THORNTON

## TWO BEDROOM + STUDY APARTMENT

UNIT 2.05 LOT 27  
UNIT 3.05 LOT 42  
UNIT 4.05 LOT 57  
UNIT 5.05 LOT 72

INTERNAL AREA: 80 m<sup>2</sup>  
EXTERNAL AREA: 11 m<sup>2</sup>

TOTAL: 91 m<sup>2</sup>

PARKING: 1

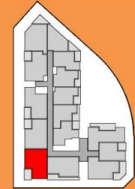

URBAN CBRE



All apartments subject to contract and availability. Images showing the building, interiors and views are computer generated prior to construction and indicative only. Dimensions, layout, finishes and specifications are subject to change and may differ from those shown. Views differ between apartments. Ground floor retail not yet confirmed. Furniture and plantings are for decorative purposes and are not included.



**SHEFFIELD  
QUARTER**  
TRENTON

**TWO BEDROOM + STUDY  
APARTMENT**

UNIT 2.04 LOT 26  
UNIT 3.04 LOT 41  
UNIT 4.04 LOT 56  
UNIT 5.04 LOT 71

INTERNAL AREA: 80 m<sup>2</sup>  
EXTERNAL AREA: 10 m<sup>2</sup>

TOTAL: 90 m<sup>2</sup>

PARKING: 1

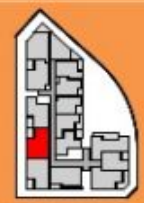

**URBAN CBRE**  
PROPERTIES



All apartments subject to contract and availability. Images showing the building, interiors and views are computer generated and are for illustrative and indicative only. Dimensions, names, features and specifications are subject to change and may differ from those shown. Views differ between apartments (shown here) and are not guaranteed. Dimensions and drawings are for illustrative purposes and are not intended.