



morton.

Penrith 504/60 Lord Sheffield Circuit

🛏 2 🚿 2 🚗 1

LEASED FOR \$500 PER WEEK. If you are a Landlord looking for a tenant, please contact David Lipman, david@morton.com.au, 0409 663 535, so we can help you find a great tenant and look after your property management. Morton are the #1 local leasing and sales agent in Thornton Estate and the #1 leasing agent for units in Penrith.

Wildwood Apartments within Sheffield Quarter is a brand new apartment development located on the north side of Penrith train station situated in the highly sought after master-planned community Thornton Estate. With uninterrupted park and district views, plus water views towards the picturesque Blue Mountains, offering convenient apartment living only metres to Penrith train station, Westfield shopping centre, local parks and quality restaurants and cafes.

- Positioned on the west side of the building with a distinctive exterior façade, perched on level 5 overlooking the water canal with stunning views of the picturesque Blue Mountains.
- Large 80sqm internal light-filled open living area with

View

As advertised or by appointment

Agent

David Lipman

📞 0409 663 535

✉ david@morton.com.au

morton.com.au



SHEFFIELD QUARTER

TRENTON

TWO BEDROOM + STUDY APARTMENT

UNIT 2.04 LOT 26
UNIT 3.04 LOT 41
UNIT 4.04 LOT 56
UNIT 5.04 LOT 71

INTERNAL AREA: 80 m²
EXTERNAL AREA: 10 m²

TOTAL: 90 m²

PARKING: 1

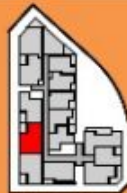

URBAN CBRE



All apartments subject to contract and availability. Images showing the building, services and views are computer generated and are for illustrative and indicative only. Dimensions, names, features and specifications are subject to change and may differ from those shown. Views differ between apartments (shown here) and are not guaranteed. Dimensions and drawings are for illustrative purposes and are not intended.



SHEFFIELD QUARTER

THORNTON

TWO BEDROOM + STUDY APARTMENT

UNIT 2.05 LOT 27
UNIT 3.05 LOT 42
UNIT 4.05 LOT 57
UNIT 5.05 LOT 72

INTERNAL AREA: 80 m²
EXTERNAL AREA: 11 m²

TOTAL: 91 m²

PARKING: 1

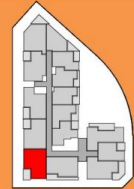

URBAN CBRE



All apartments subject to contract and availability. Images showing the building, interiors and views are computer generated prior to construction and indicative only. Dimensions, layout, finishes and specifications are subject to change and may differ from those shown. Views differ between apartments. Ground floor retail not yet confirmed. Furniture and plantings are for decorative purposes and are not included.