



# morton.

**Pymont** B803/24-26 Point Street

1 1 1

An elevated setting within the sought-after 'Watermark' complex gives this stylish apartment a prime harbourside position capturing panoramic views of the Harbour Bridge and city skyline. With access to the complex's resort amenities, it offers the ultimate in low maintenance apartment living with a highly convenient executive lifestyle to match.

- Sun-drenched living and dining area with enviable north-east aspect
- The double-sized bedroom has built-ins and balcony access
- Practical enclosed study/guest bedroom
- Well-appointed modern kitchen and gas fittings
- Full brick construction, internal storage and full laundry
- Security parking plus an extra lock-up storage space
- Full building security, lift access and visitor parking
- Access to the community's 25m swimming pool and gym

## View

As advertised or by appointment

## Agents

### Ian Qiu

0447 696 425

ian@morton.com.au

### James Crow

0410 593 057

james@morton.com.au

**morton.com.au**

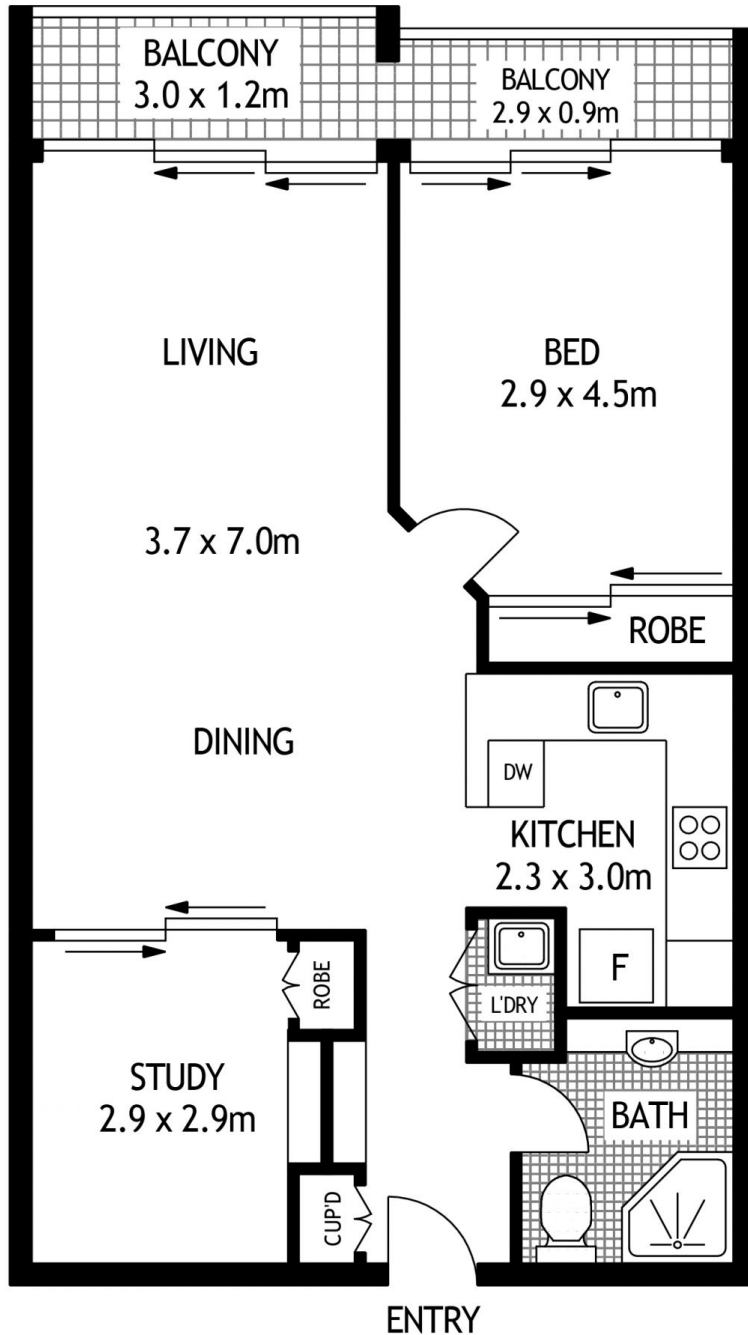

LEVEL EIGHT

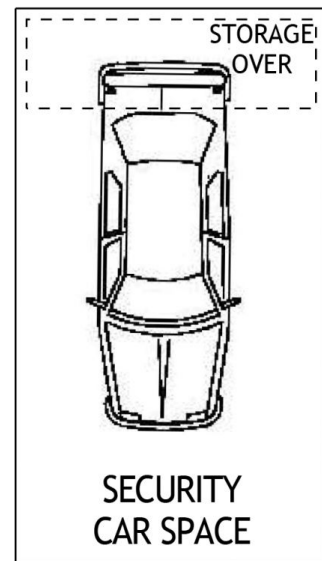

BASEMENT 2



**B803/24-26 POINT STREET**

**PYRMONT**

SCAPE Floor Planing Disclaimer: This floor plan is conceptual only. it is provided for illustrative purposes only and should not be relied upon. We make no guarantees to the correctness of this plan. All interested parties should make and rely on their own enquiries in determining the accuracy of the information contained in this floor plan.