



morton.

Wentworth Point 762/3 Baywater Drive

🛏 2 🚿 2 🚗 2

The Waterfront is located moments to Sydney Olympic Park main venues, train station, Bicentennial Park and Millennium Parklands. Located in Palermo, this is your opportunity to move into this one bedroom apartment only a short stroll from The Promenade and The Piazza.

- Located on level seven.
- Combined living and dining rooms
- Reverse cycle air conditioning
- Full kitchen with stainless steel appliances
- Gas cooking and lots of cupboard space
- Great size bedrooms with built-in wardrobes
- Laundry room and clothes dryer
- Secure undercover tandem car spaces and a storage cage
- Palermo building includes exclusive gym and pool

View

As advertised or by appointment

Agent

Morton RE

📞
✉ rentals@morton.com.au

morton.com.au

- ENTRY 1
- LIVING 2
- DINING 3
- KITCHEN 4
- MAIN BEDROOM 5
- ENSUITE 6
- BEDROOM 2 7
- BEDROOM 3 8
- BATHROOM 9
- LAUNDRY 10
- LINEN 11
- BALCONY 12
- CLOTHES DRYING 13
- STORE 14

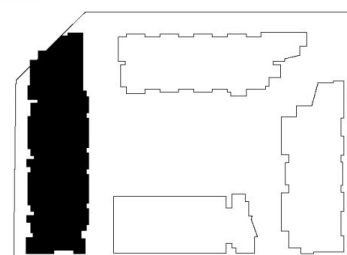

PALERMO

LEVEL 07

UNIT: **762**

TYPE: 3 Bedroom

UNIT AREA: 122.0 sqm

OUTDOOR AREA: 20.0 sqm



Disclaimer: All layouts are indicative only, and subject to change.

ALLEN JACK+COTTIER



0 2.5 5M