



**morton.**

**Woolloomooloo** 356/6 Cowper Wharf Roadway

 1  1

Bathed in morning sunlight and blessed with views that stretch uninterrupted across the water to Garden Island and Potts Point. This impressive studio apartment offers an amazing opportunity to enter what is most certainly one of Sydney's most sought-after and prestigious harbour communities. With a stunning renovation throughout, this apartment is a must to inspect.

- Complete with original maritime finishes throughout
- Low maintenance living with open entertaining areas
- Chic integrated kitchen has gas fittings, granite benches
- With historic exposed beams and steel support work
- Ducted air conditioning, 24 hr security, internal laundry
- Within a breath of harbour walks, cafes and restaurants

**View**

As advertised or by appointment

**Agent**

**Sarah Fowell**



 sarah@morton.com.au

**morton.com.au**

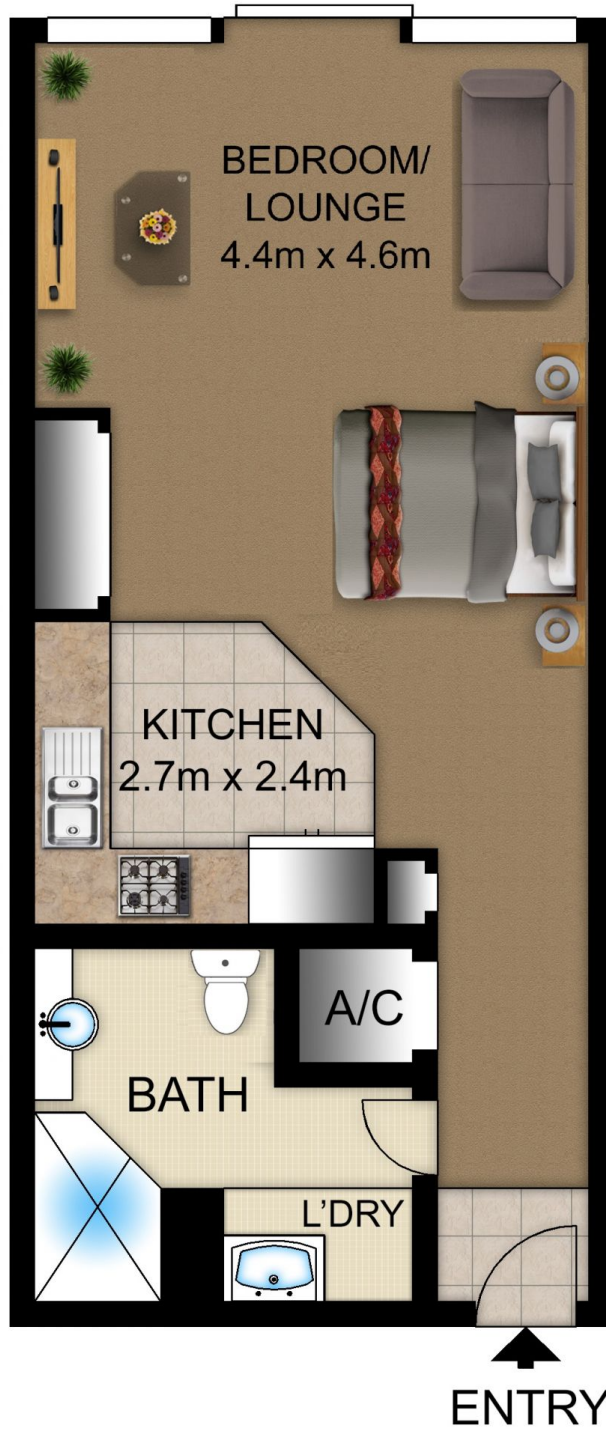

morton.

356/6 Cowper Wharf Road, WOOLLOOMOOLOO

Not to scale • All measurements are approximate • Drawn for marketing purposes only • Floorplan by © Industrie Media

