



**morton.**

**Lane Cove North** 111/450 Pacific Highway



Ideal for investors or first home buyers alike, it presents a wonderful opportunity to secure a property in the resort-style 'Shore Apartments'. Peacefully positioned at the rear of the block, enjoying a prized north east aspect and tranquil surrounds, this fabulous apartment is ready for you to move into and make it your own.

- Ideal investment with rental potential of \$360 pw
- Generous combined living/sleeping accommodation
- Functional and recently updated galley kitchen
- Newly carpeted, reverse cycle air-con throughout
- Bright, elevated leafy outlook, plenty of visitor parking
- Resort facilities include pool, sauna, spa, tennis court, gym

Set in an ultra-convenient locale with buses at your door providing easy access to CBD and Chatswood, it's only a short stroll to the Lane Cove interchange, Artarmon station and Lane Cove Village shops and restaurants and a few minute's drive to Chatswood shopping enclave.

#### View

As advertised or by appointment

#### Agents

##### Lucy White

- ☎ 0413 930 760
- ✉ lucy@morton.com.au

##### Konstantin Melnikov

- ☎ 0421 540 424
- ✉ konstantin@morton.com.au

**morton.com.au**

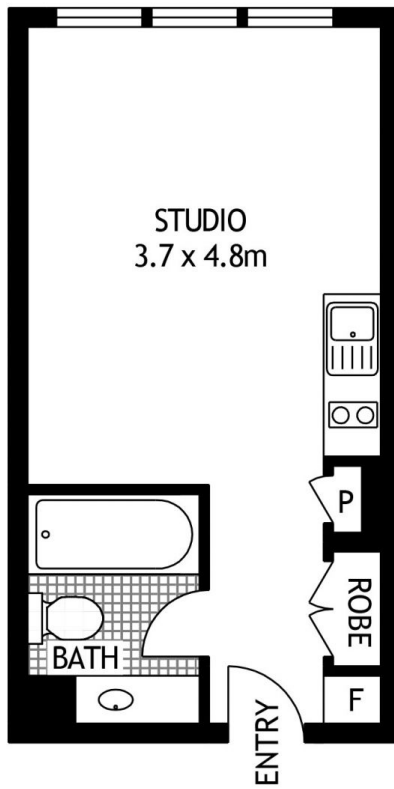

FOURTH FLOOR



111/450 PACIFIC HIGHWAY

LANE COVE

SCAPE Floor Planing Disclaimer: This floor plan is conceptual only. It is provided for illustrative purposes only and should not be relied upon. We make no guarantee as to the correctness of this plan. All interested parties should make and rely on their own enquiries in determining the accuracy of the information contained in this floor plan.