



morton.

Wentworth Point 609/8 Baywater Drive

 2  2  1

The Waterfront is located moments to Sydney Olympic Park main venues, train station, Bicentennial Park and Millennium Parklands. Located in Messina, this is your opportunity to move into this two bedroom apartment, only a short stroll from The Promenade and The Piazza.

- Good size balcony
- Combined living and dining rooms
- Air conditioning in the lounge room
- Natural ventilation throughout the unit
- Gas cooking and quality finishes throughout
- Good size bedrooms with built-in wardrobes
- Laundry room and clothes dryer
- Single car space and storage cage

View

As advertised or by appointment

Agent

Sarah Fowell

 0437 492 129

 rentals@morton.com.au

morton.com.au

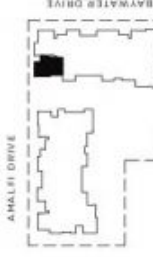

MARINE PARADE

LOCATION

UNIT 609
2 BEDROOM

INTERNAL	85 sqm
BALCONY	29 sqm
TOTAL AREA	114 sqm

KEY:

- 1 Entry
- 2 Living
- 3 Dining
- 4 Kitchen
- 5 Bedroom 1
- 6 Bedroom 2
- 7 Wardrobe
- 8 Bathroom
- 9 Ensuite
- 10 Laundry
- 11 Store
- 12 Balcony

28.10.2010
REV. D



Exclusion: The architect is not liable for the accuracy of the building plan and does not warrant its use for any other purpose. All measurements, dimensions, areas, etc. are approximate and subject to change without notice. The architect is not liable for the accuracy of the building plan and does not warrant its use for any other purpose. The architect is not liable for the accuracy of the building plan and does not warrant its use for any other purpose. The architect is not liable for the accuracy of the building plan and does not warrant its use for any other purpose.