



**morton.**

**Ermington** 106/48-56 Bundarra Street

 2  2  1

Peacefully positioned in Ermington's foremost waterfront community, this stunning apartment offers a lifestyle of understated luxury throughout. Beautifully presented with clean architectural lines, this is the perfect home for the investor, downsizer or first-time owner seeking the ultimate in riverside living.

- Opening to the ambient light of a Northern aspect
- Flawlessly appointed with absolutely nothing to add
- Formal/casual entertaining spaces, winter garden
- Double bedrooms, built-ins, master has an ensuite
- Deluxe kitchen, stone benches and gas appliances
- Air conditioning, soaring ceilings and floating floors

**View**

As advertised or by appointment

**Agent**

**Dylan Choe**

 0416 932 977

 [dylanchoe@morton.com.au](mailto:dylanchoe@morton.com.au)

[morton.com.au](http://morton.com.au)

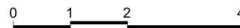

JOINTLY DEVELOPED BY



Disclaimer: This floor plan has been prepared for marketing purposes only. All descriptions, dimensions, depictions and other details in this floor plan may not be to scale and may vary from the property as built. Your attention is drawn to the special conditions of the contract for sale of land. No third party has any authority to make or give any representation or warranty in relation to the property unless the representation or warranty is confirmed by the vendors and included in the contract for sale of land. Date Issued: 05/12/14 Revision: C

SALES BY



**ROYAL SHORES**  
SYDNEY HARBOUR

**SAFARI I**  
Ⓝ  
**APARTMENT 106**  
**LOT 5**

2 BEDROOM

Internal (including Winter Garden)	96 sqm
External	6 sqm
<b>Total</b>	<b>102 sqm</b>

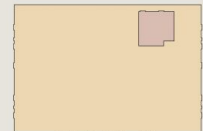

SAFARI I - LEVEL 1

**ROYAL SHORES DISPLAY CENTRE**  
1 Burdarra Street, Ermington NSW 2115  
P 1300 888 558 W royalshores.com.au