



morton.

RYDE 18/2-4 Eagle Street

 2  1  1

Stylishly appointed and filled with light, this top floor apartment displays spacious contemporary interiors and tranquil, green district views from its large picture windows. Quiet and peaceful its convenient location is a short walk to shops, restaurants, parks and transport.

- Fully renovated, contemporary interiors
- Spacious lounge, dining, tranquil deck
- Easy care stylish tiling, built-in study niche
- Stylish stainless steel kitchen, induction cook top
- Separate laundry with ample storage
- Two large bedrooms, built-in robes, fans
- Sleek designer bathroom, modern lighting
- Large lock up garage, storage, work space
- Security building, walk to shops, transport

View

As advertised or by appointment

Agent

Sarah Fowell

 0437 492 129

 sarah@morton.com.au

morton.com.au

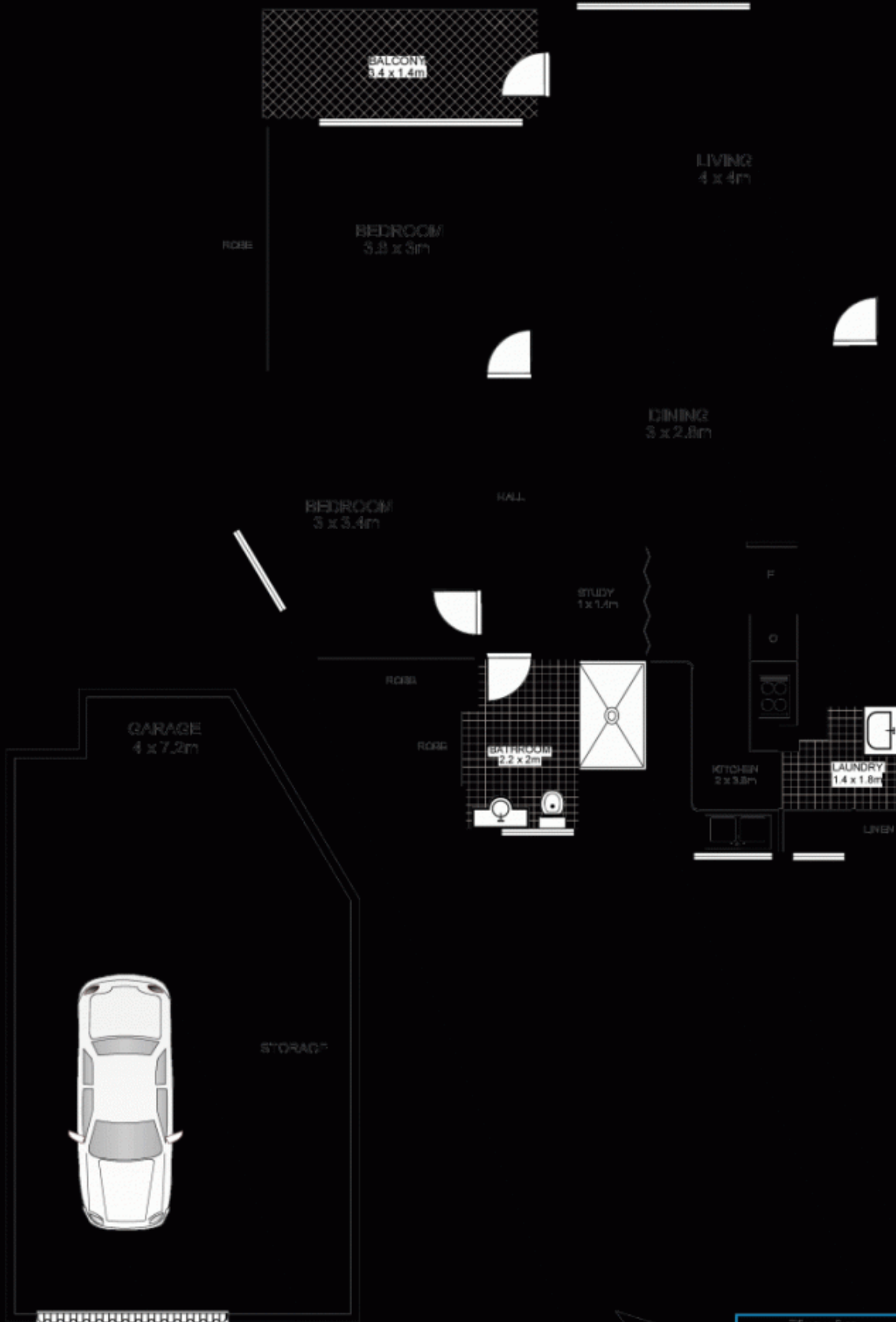

This floor plan is intended as a guide only. It is not a contract. All dimensions are approximate only. No representation or warranty is made as to the accuracy of any measurements or dimensions shown or intended. Any person using this information should rely on their own enquiries.





 1 800 30 322 400