



morton.

WOOLLOOMOOLOO 18 Bland Street

 2  1

This double storey late Edwardian terrace offers convenient city and harbour front living. Situated in a quiet cul-de-sac across the road from the Woolloomooloo Finger Wharf. This rare two bedroom terrace is a short walk to Woolloomooloo's world famous restaurants, the CBD, Botanic Gardens and Potts Point. This is a perfect location for care free city living.

- Combined living and dining room
- Polished timber floors
- Period features with an ornate fireplace
- Renovated galley style kitchen
- Gas appliances, separate laundry
- Master bedroom with Juliette balcony
- Second bedroom ideal for guest room or study
- Sunny rear courtyard
- Moments walk to CBD and Potts Point

View

As advertised or by appointment

Agent

Noel Jenkins

 0410 593 694

 noel@morton.com.au

morton.com.au

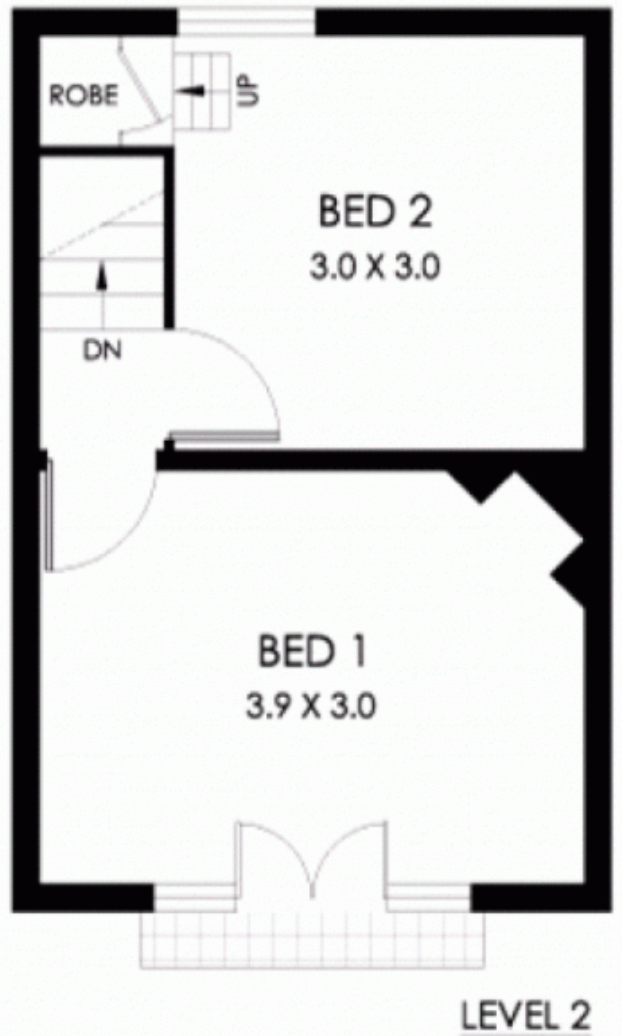

0 1 2 3 SCALE (METRES)
 PLANS SHOWN ARE ONLY INDICATIVE OF LAYOUT. DIMENSIONS ARE APPROXIMATE

All information contained herein is gathered from sources we believe to be reliable, however we cannot guarantee its accuracy and interested persons should rely on their own enquiries. Dimensions are approximate.

