



morton.

Sydney 1209/185-211 Liverpool Street

 2  2  1

Directly opposite Hyde Park, this fantastic CBD address at The Connaught is coveted by many but enjoyed only by a privileged few. Holding a prime corner position on the 12th floor, this sophisticated two bedroom apartment reveals generously sized, flowing interiors and features two balconies with sweeping city views. Indulge in the luxurious roof top spa level or step out to sample the best restaurants and nightlife Sydney has to offer with Oxford Street and Surry Hills just a short walk away.

- Delightfully bright and fresh 97sqm apartment
- Open plan living and dining with entertainer's balcony
- Sleek renovated kitchen with Miele appliances
- Two double bedrooms with built-in robes, main with ensuite
- Peaceful 2nd balcony accessed by both bedrooms
- Ultra-chic well appointed main bathroom
- Ducted air con; internal laundry and ample storage
- Intercom access and 24 hour concierge
- Single secure car space
- Resident's rooftop retreat with pool, spa, saunas and

morton.com.au

View

As advertised or by appointment

Agent

Morton RE



 info@morton.com.au

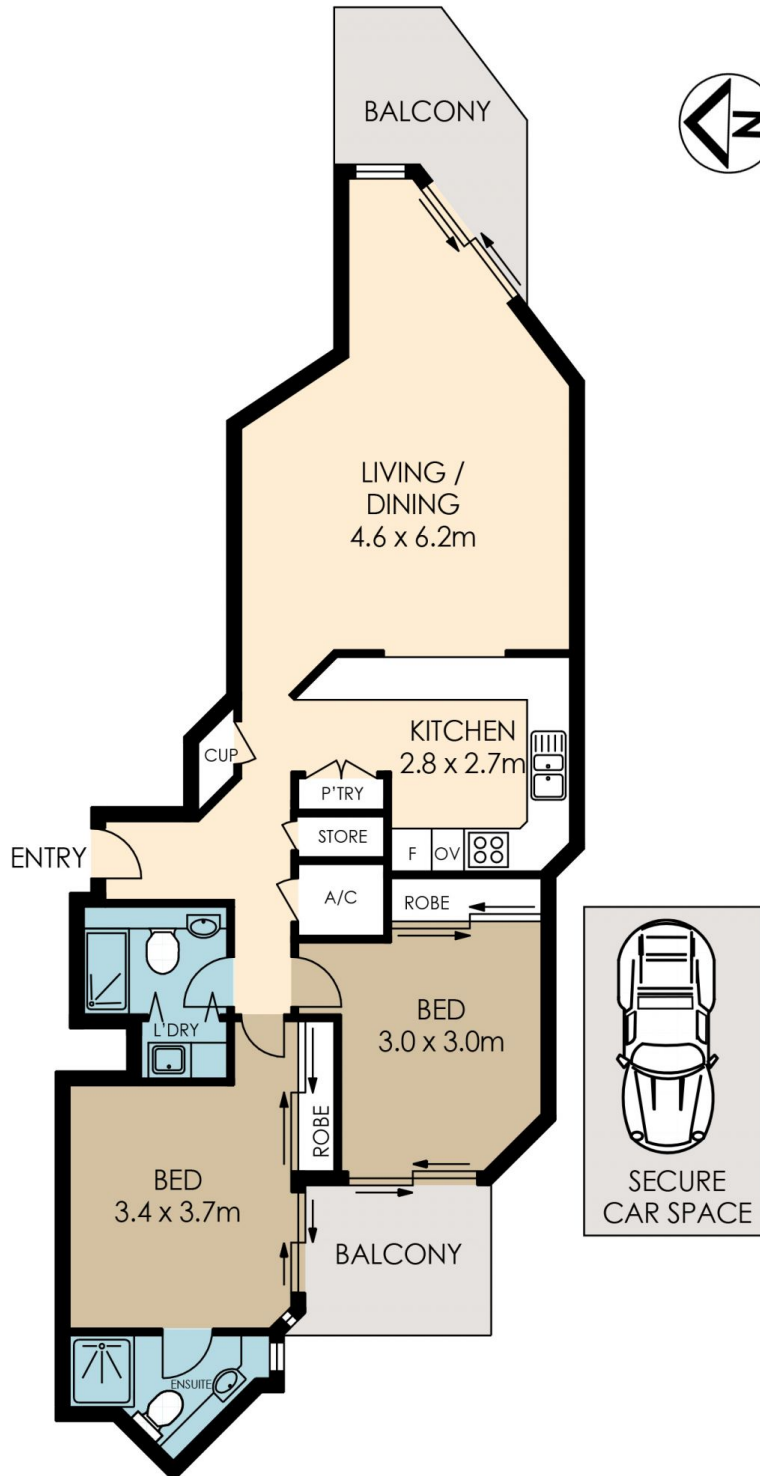

1209/185-211 Liverpool Street, Sydney

The information above is provided in good faith and has been provide to us from a variety of sources. We have not verified whether the information is accurate and do not have any belief one way or other in its accuracy. We do not accept any responsibility to any person for its accuracy and do no more than pass it on. All interested parties should rely on their own inquiries in order to determine whether or not this information is in fact accurate.