



**morton.**

**WENTWORTH POINT** 4 The Crescent

 2  2  1

This prestige apartment on the ground and first levels of the highly regarded Valencia building includes two external terrace areas. The ground floor terrace provides access to the pool courtyard. High quality finishes that you would expect in a premium building including stainless steel appliances, microwave and dishwasher, polyurethane finished cabinets and Italian tiles, two bedrooms; one on each level, ducted air conditioning, excellent storage cupboards under stairs and storage cage in basement.

**Features :**

- \* Two bedrooms; one on each level
- \* Ducted reverse cycle air conditioning
- \* Internal storage cupboards and external storage cage
- \* Outdoor pool complex for building residents only
- \* Ground floor access from terrace to pool facility
- \* Audio/ visual security intercom
- \* Secure basement parking
- \* Access to Pulse Lifestyle Club, gym, heated pool, tennis courts

**morton.com.au**

**View**

As advertised or by appointment

**Agent**

**Sarah Fowell**

 0437 492 129

 rentals@morton.com.au



LOWER

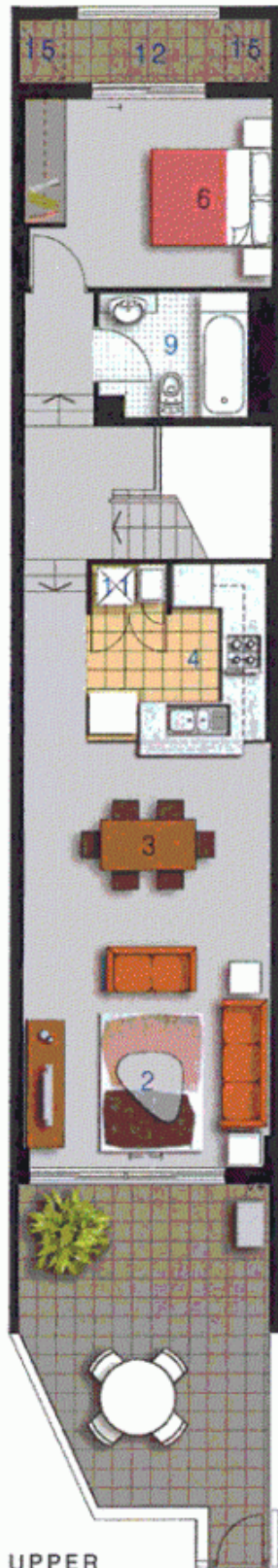

UPPER

|                |    |
|----------------|----|
| ENTRY          | 01 |
| LIVING         | 02 |
| DINING         | 03 |
| KITCHEN        | 04 |
| BEDROOM 1      | 05 |
| BEDROOM 2      | 06 |
| BATHROOM       | 09 |
| ENSUITE        | 10 |
| LAUNDRY        | 11 |
| BALCONY        | 12 |
| TERRACE        | 13 |
| STORAGE        | 14 |
| CLOTHES DRYING | 16 |

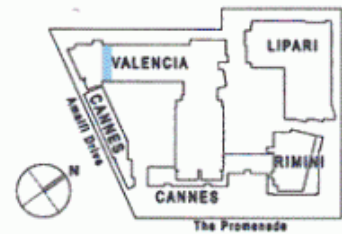

# valencia

Unit 273

Lot Number 3  
 Type 2 Bedroom  
 Unit Area 89m<sup>2</sup>  
 Balcony 4m<sup>2</sup>  
 Terrace 38m<sup>2</sup>  
 Total 131m<sup>2</sup>  
 Scale 1:100



Disclaimer: All Layouts are indicative only, and subject to change.

0 2.5 5M