



morton.

North Sydney 1005/245 Pacific Highway

 2  2  1

Set in a superb location convenient to both local/CBD transport. Located only a few moments away from cafes, restaurants and the CBD.

- Spacious open plan living and kitchen
- Sizeable balcony with district views
- Modern galley style kitchen, gas cooking and dishwasher
- Internal laundry with dryer
- Under cover parking and storage cage
- Secure building with intercom and lift access
- Rooftop terrace with cinema and harbour views
- Air conditioning throughout

View

As advertised or by appointment

Agent

Sarah Fowell

 0437 492 129

 sarah@morton.com.au

morton.com.au

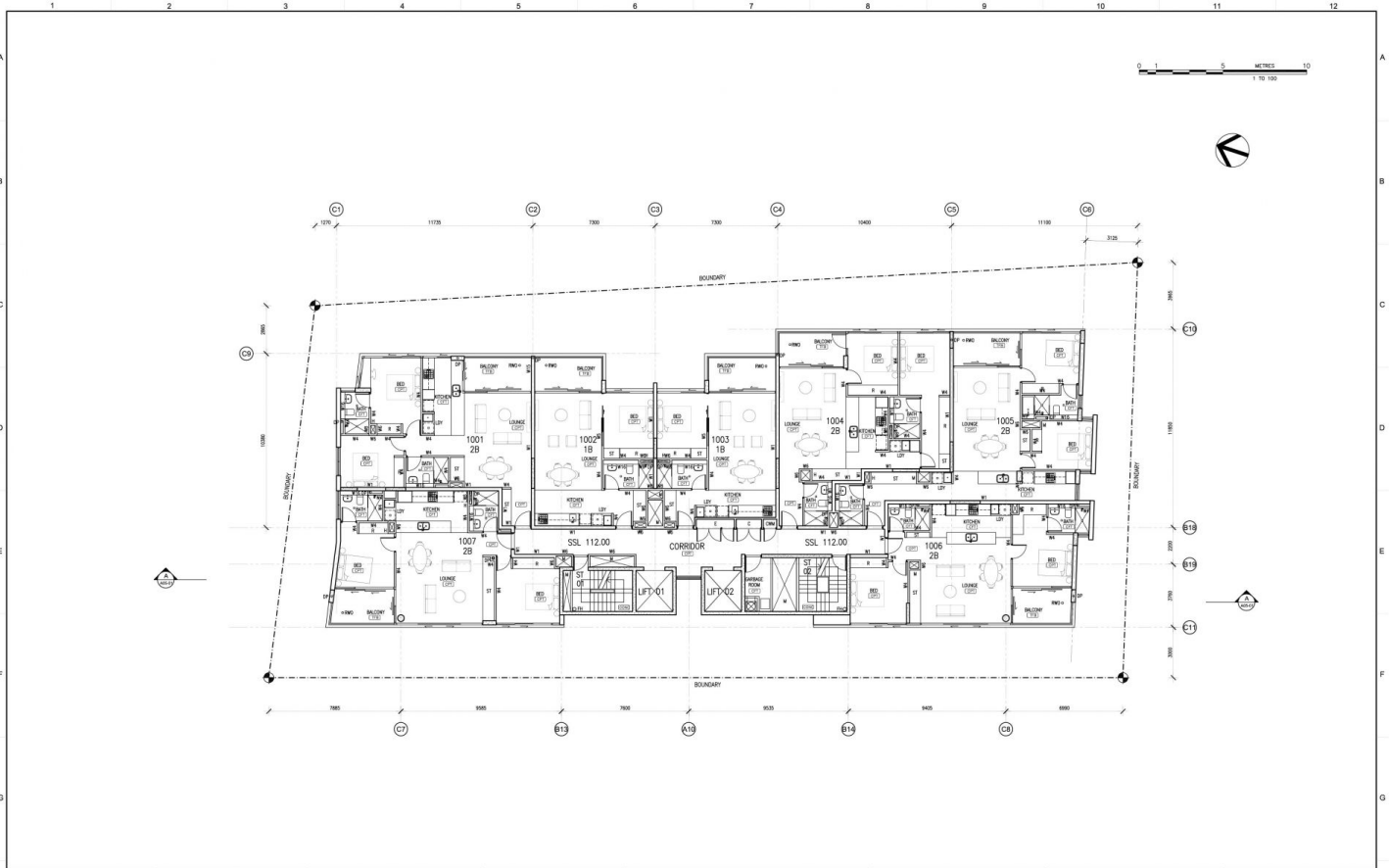

QUALITY CHECK				AMENDMENTS		NOTES		NOTES		CLIENT		DRAWING	
Design Approvals	Drawn	Checked	Client	Date	No.	Date	Notes	Notes	Client	Project	Project No.	DWG No.	Scale
JIA CC CD HODDER BAKER ARCHITECTURE SYDNEY					1	20/11/20		Notes: 1. All dimensions and levels are to be confirmed on site. 2. Dimensions are to be taken in conjunction with all related documents. 3. Use reported dimensions only. Do not scale from drawings. 4. Calside Group Pty Ltd cannot guarantee the accuracy of content and errors for issues of drawings issued electronically. 5. The completion of the work shall constitute the authorisation of the content of the drawings. The drawings shall not be used for construction purposes without the written consent of Calside Group Pty Ltd.	Noted Architect: Shaheen Calside Registration No. 4205 CALDIS ARCHITECTS LEVEL 4 45 CHAPPEL STREET CHIPPENHAW NSW 2008 TEL: 02 9519 9277 FAX: 02 9519 9277 A/CN 05 302905 www.calside.com.au Email: projects@calside.com.au A/CN 05 302 900	HINDMARSH CONSTRUCTION LEVEL 22/25 BLIGH STREET SYDNEY NSW 2000 PROJECT 'MONTROSE APARTMENTS' 238-247 PACIFIC HIGHWAY NORTH SYDNEY NSW 2060	LEVEL 10 FLOOR PLAN PROJECT No. 12-309 DWG No. A01-14 SCALE 1:100		