



morton.

Chippendale 14/33 Goold Street

 1  1  1

This large one bedroom apartment has a clever layout to maximize space and usability. Located just a short walk to Central Station and Parramatta Road, tucked away from all the noise and traffic.

- Brand new paint and carpet
- Open plan kitchen and living area
- Stainless steel appliances, gas stove and dishwasher
- Granite bench tops
- Large bedroom with mirrored built in wardrobe
- Modern bathroom with bath and shower over
- Concealed internal laundry
- Secure building with intercom
- Undercover car space

View

As advertised or by appointment

Agent

Morton RE



 rentals@morton.com.au

morton.com.au

14/33 Goold Street, Chippendale

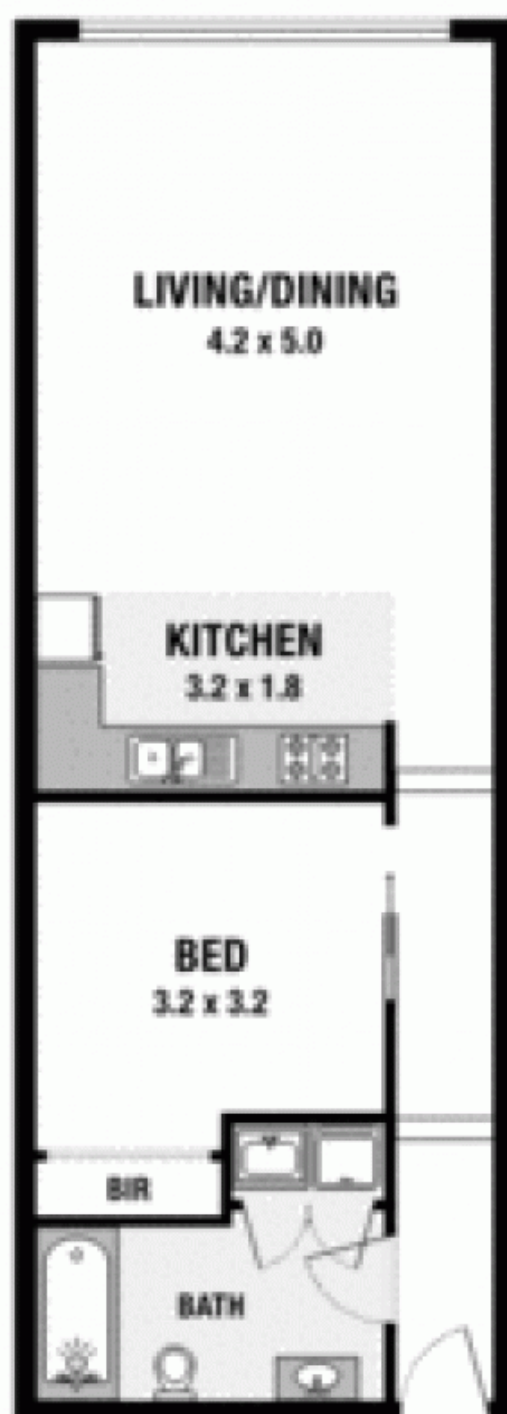

CAR SPACE