



**morton.**

**Sydney** 805/45 Shelley Street

🛏 2 🚿 2 🚗 1

Set in a blue ribbon precinct, this ultra spacious executive apartment is just moments away from the CBD and within easy reach of countless other attractions.

- Fully furnished
- Stroll comfortably to the buzz of King Street Wharf & the office
- North-facing entertainers' balcony with spectacular water views
- Ultra spacious sun-filled open plan lounge-dining area
- Two double bedrooms with built-ins & master with ensuite
- Designer kitchen with Corian bench tops & s/s Blanco range
- Luxurious mosaic main bathroom with hideaway laundry
- Undercover security car space for one car, security intercom

**View**

As advertised or by appointment

**Agent**

**Morton RE**

📞  
✉ rentals@morton.com.au

**morton.com.au**

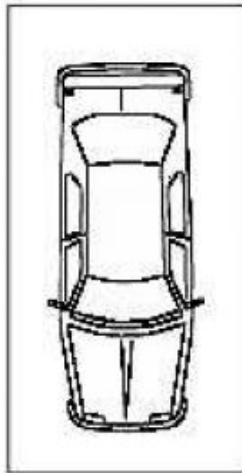

NOTE : ONE CAR SPACE  
AVAILABLE ON  
SECURITY PARKING

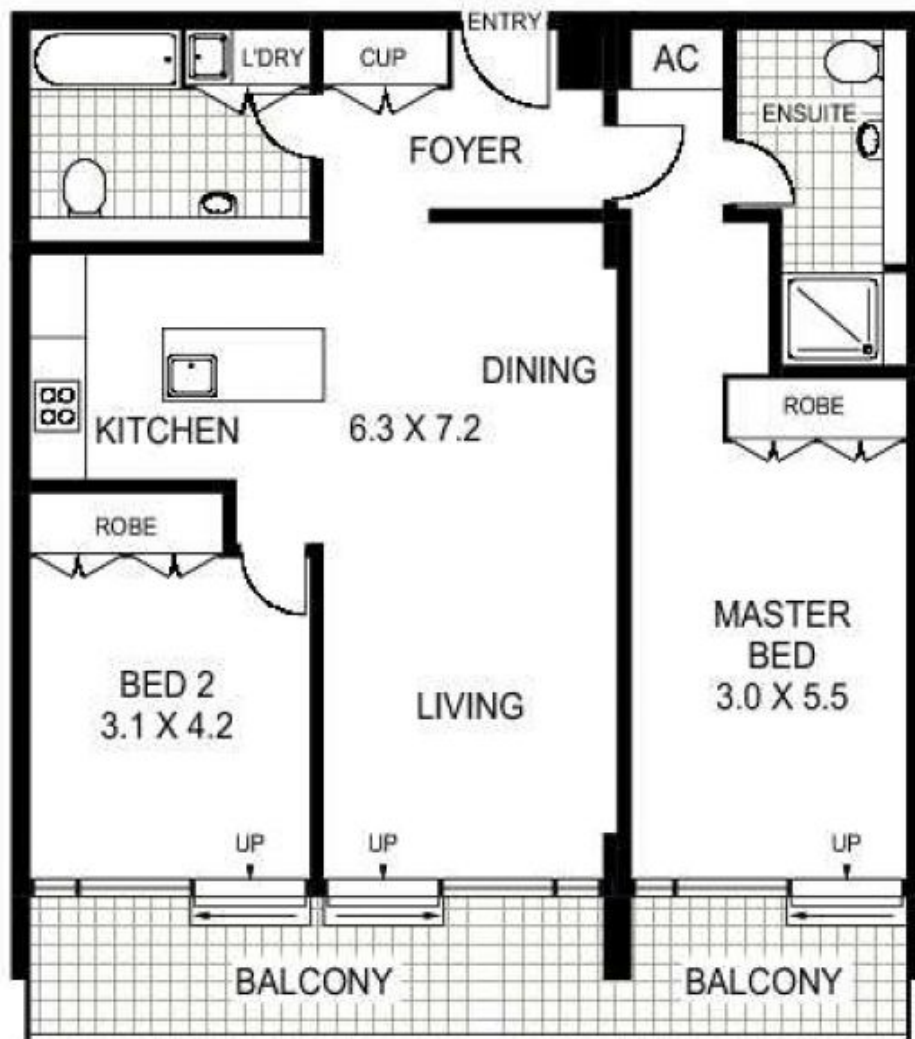

805/45 SHELLEY STREET

SYDNEY

Floor Plan Disclaimer: Mind the Gap (mtg) floor plans / site plans are intended as a guide only. No representations or warranties of any nature whatsoever are given or intended and any person using this information should always rely on their own enquiries. mtg property marketing services - 1300 133 145 - photography, floor plans, virtual tours, video tours, copywriting, project marketing - [www.mindthegap.com.au](http://www.mindthegap.com.au)