



morton.

Huntleys Cove 5/1 Fryar Place

 4  3  2

Located in the much sought after Huntley's Cove estate this enormous four bedroom home is set over three levels and will appeal to families seeking space, recreation facilities and convenience to transport.

- Large open plan lounge and dining timber floors
- North facing balcony from each level with bushland views
- Kitchen with granite bench tops, European appliances and dishwasher
- Top floor master bedroom with walk in robe, en-suite with spa bath
- Two additional bedrooms with built-ins open to a third balcony
- Lower level offers a massive family room opening onto a fourth balcony
- Rest room and storage area are also located on the lower level
- Air conditioning, internal laundry with dryer, excellent security
- Automatic double lock up garage
- Resort style facilities include tennis court, swimming pool,

View

As advertised or by appointment

Agent

Morton RE



 rentals@morton.com.au

morton.com.au

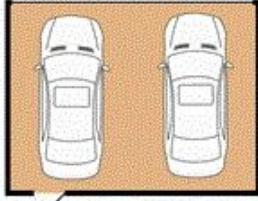

DOUBLE GARAGE
7.0m x 5.0m

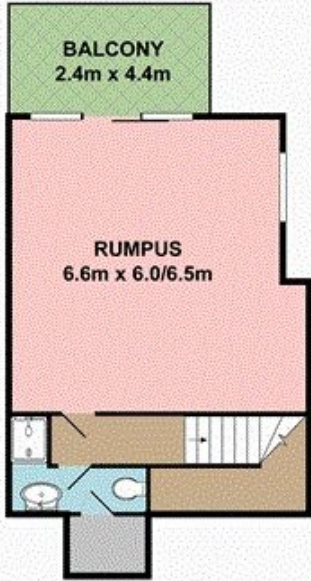

GROUND FLOOR

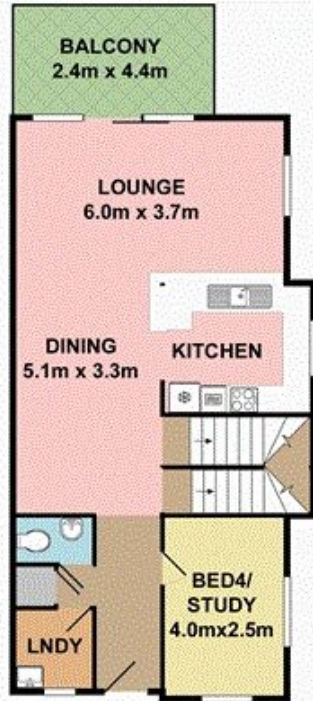

ENTRY LEVEL

TOTAL APPROX. FLOOR AREA 253.3 SQ.M. (2727 SQ.FT.)
Measurements are approximate. Not to Scale. For illustrative purposes only.

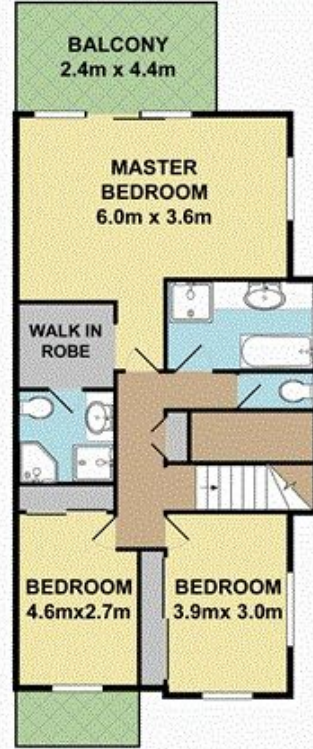

1ST FLOOR

