



morton.

Wentworth Point 423/45 Amalfi Drive

2 2 2

The Waterfront is located moments to Sydney Olympic Park main venues, train station, Bicentennial Park and Millennium Parklands. Located in Corsica, this is your opportunity to move into this two bedroom apartment only a short stroll from The Promenade and The Piazza.

- Located on level four
- Combined living and dining room
- Full size kitchen with stainless steel appliances
- Gas cooking and lots of cupboard space
- Great size bedrooms with built ins
- Laundry room and clothes dryer
- Secure basement tandem car spaces and large storage cage

View

As advertised or by appointment

Agent

Morton RE

rentals@morton.com.au

morton.com.au

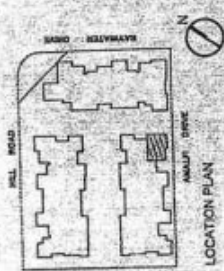

UNIT 423

2 BEDROOM

INTERNAL AREA : 88 sqm
TERRACE AREA : 22 sqm
TOTAL AREA : 110 sqm

ENTRY	01
LIVING	02
DINING	03
KITCHEN	04
BEDROOM1	05
BEDROOM2	06
WARDROBE	07
ENSUITE	08
BATHROOM	09
LAUNDRY	10
STORE	11
BALCONY/COURTYARD	12



Disclaimer: The particulars are set out as a general outline for the guidance of intending purchasers and do not constitute an offer or contract. All descriptions, dimensions, references to conditions and necessary permissions for use and other details are given in good faith and are believed to be correct, but any intending purchasers should not rely on them as statements or representations of fact, but must satisfy themselves by inspection or otherwise as to the correctness of each item, and where necessary seek independent advice. No third party supplier or their agents has any authority to make or give any representations or warranty in relation to this property. * External areas may be larger for courtyard apartments. Refer to the detailed area schedule.