



# morton.

Woolloomooloo 206/6 Cowper Wharf Roadway

🛏 2 🚿 1 🚗 1

Serenely set In the exclusive Finger Wharf complex, this original level 2 city facing apartment is bathed In natural light and will give buyers the opportunity to add their own Improvements. Full length glass windows capture sweeping views across the marina, Botanical Gardens and CBD. Admired by all, the historic building also houses the popular Ovolo hotel and Sydney's finest restaurants.

- Open plan living room
- Master bedroom with built Ins
- 2nd bedroom/study
- Gas Kitchen, stone benchtops
- Internal laundry
- Reverse cycle aircon
- Parking on separate title In Lincoln Crescent

### View

As advertised or by appointment

### Agents

#### Noel Jenkins

📞 0410 593 694  
✉ noel@morton.com.au

#### Amanda Clement

📞 0448 016 404  
✉ amanda.clement@morton.com.au

[morton.com.au](http://morton.com.au)

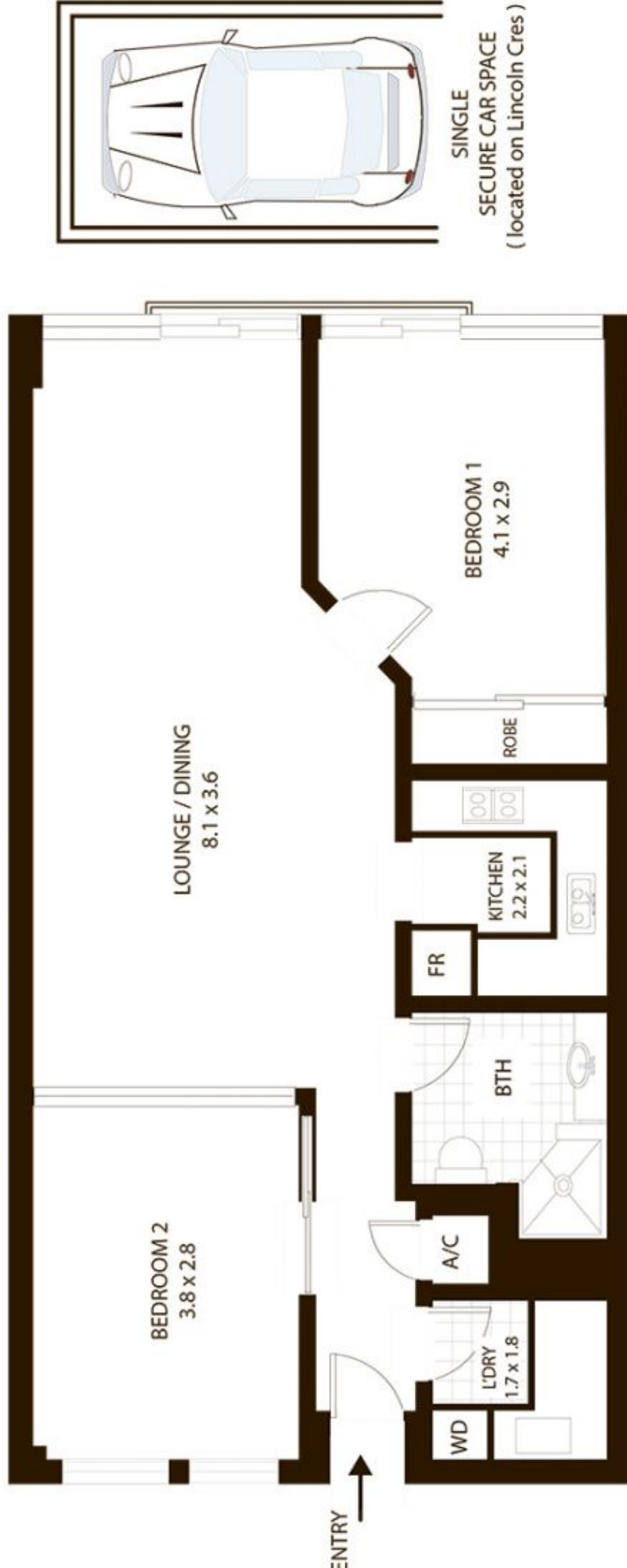

# 206/6 Cowper Wharf Road, Woolloomooloo

All measurements are approximate only. Plan is provided as an indication of layout



SCALE