



morton.

Woolloomooloo 451/6 Cowper Wharf Roadway

1 1

Beautiful harbour side studio in the unique heritage listed Finger Wharf at Woolloomooloo. East facing harbour views capturing the shimmering morning sun enjoy waterfront living through the floor to ceiling glass sliding doors. This harbour-front apartment is the ultimate Sydney base, investment, or full-time home.

- Prestigious location in the historic 'Finger Wharf' building
- Sublime views span across the water to Potts Point & Garden Island
- Open plan studio living
- Floor-to-ceiling glass to soak up waterfront views
- Galley style gas kitchen with granite benchtops
- Built in wardrobes and additional storage
- Internal laundry, 24 hr on site security
- Ducted air conditioning, louvered windows, full-sized glass doors
- Set atop some of Sydney's top restaurants and cafés
- Moments walk to CBD and Botanic Gardens

View

As advertised or by appointment

Agents

Noel Jenkins

0410 593 694
noel@morton.com.au

Amanda Clement

0448 016 404
amanda.clement@morton.com.au

morton.com.au

**451/6 Cowper Wharf Road,
WOOLLOOMOOLOO**

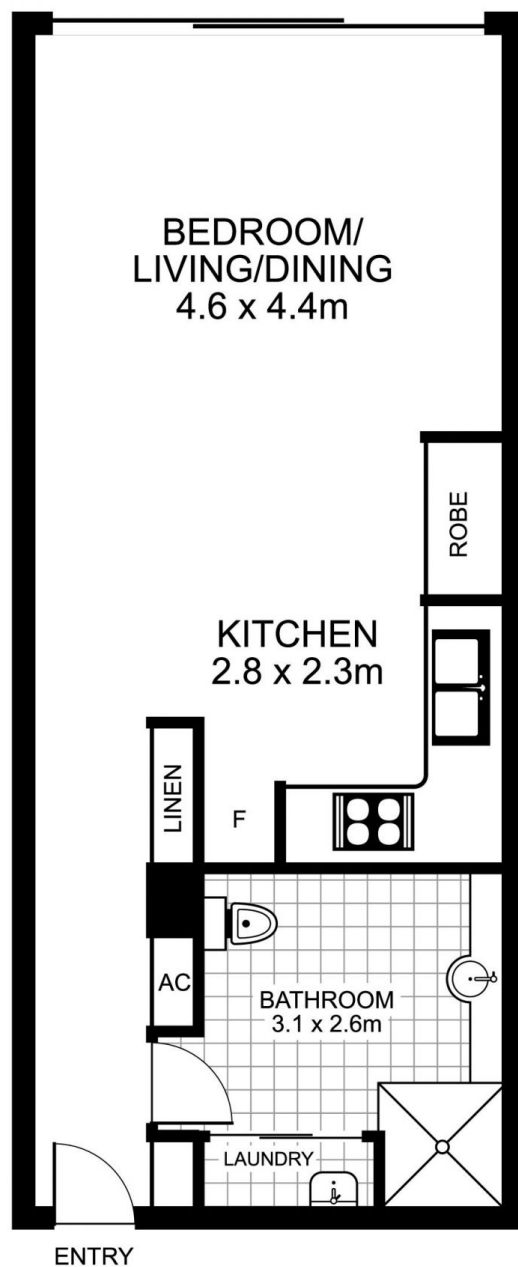

This floor plan is intended as a guide only. Layout dimensions are approximate only. No representations or warranties of any nature whatsoever are given or intended. Any person using this information should rely on their own enquiries