



morton.

Pyrmont 143/120-140 Pyrmont Street

 2  2  1

Situated on the city's edge, this spacious and beautifully presented apartment offers an amazingly peaceful setting, a versatile floor plan and light-filled ambience, with the ultimate convenience of being just a short walk across Pyrmont Bridge and into the city centre.



- Formal and informal living plus dining with timber floors
- Opens to enclosed sun room and second sundrenched balcony
- Master bedroom with walk in wardrobe and ensuite with bathtub
- Equally spacious second bedroom with built-in wardrobes
- Superb kitchen, ample bench space and stainless steel appliances
- Full sized laundry with shelving
- Ample amount of internal storage, large lock-up garage
- Full building security with concierge
- Rooftop entertaining deck with stunning Sydney views
- Other facilities include spa, sauna and well equipped gym

View



As advertised or by appointment

Agents

Nicole Beckett

 0409 896 152
 nicole@morton.com.au

Naomie Texier

 0439 247 710
 naomie@morton.com.au

morton.com.au

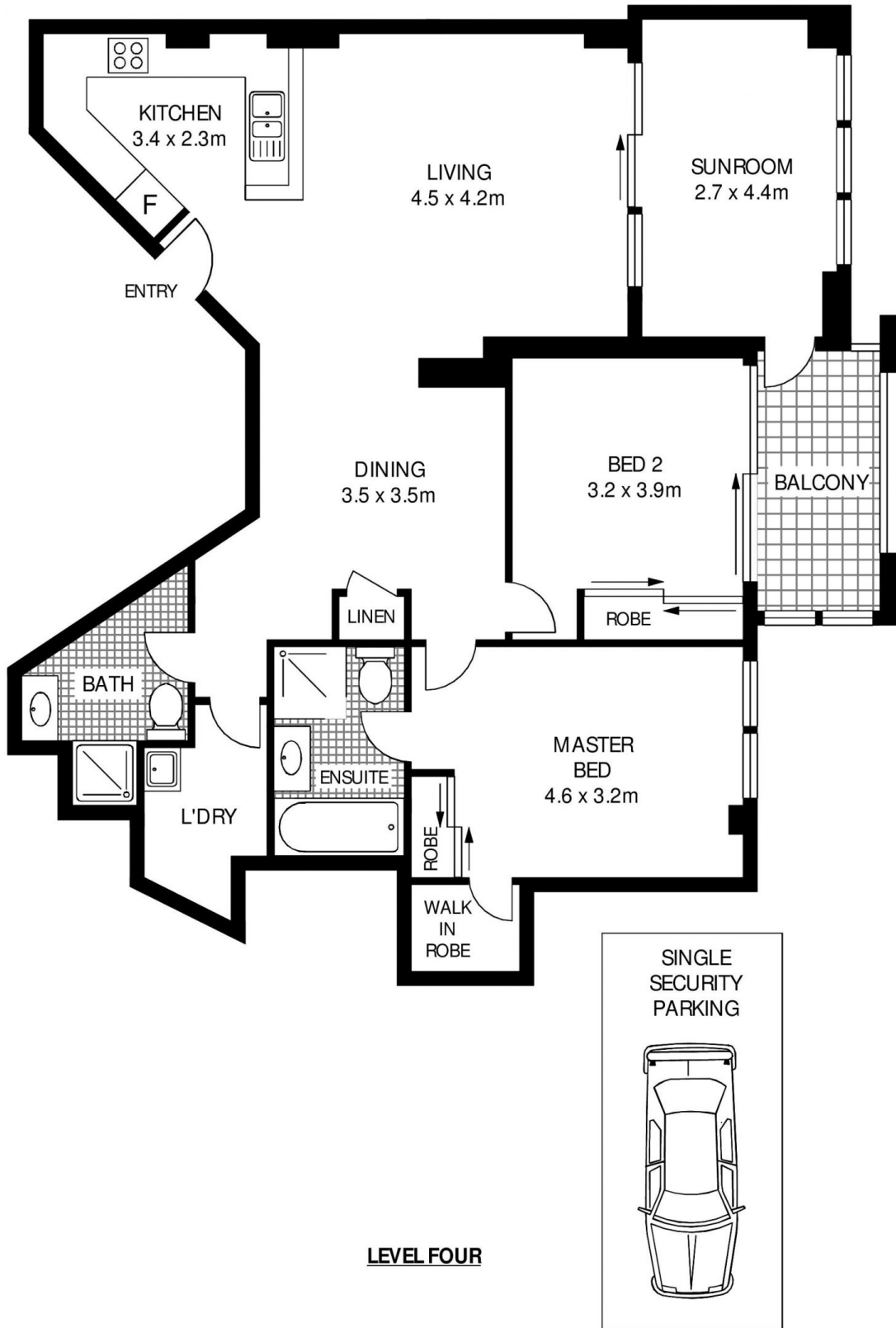

143/120 PYRMONT STREET

PYRMONT

SCAPE Floor Planning Disclaimer: This floor plan is conceptual only. It is provided for illustrative purposes only and should not be relied upon. We make no guarantee as to the correctness of this plan. All interested parties should make and rely on their own enquiries in determining the accuracy of the information contained in this floor plan.