



# morton.

**Wentworth Point** 1010/2 Waterways Street



Offering the perfect executive lifestyle package, this one-bedroom residence's light-filled spaces and easy low-maintenance design are enhanced by an elevated position with fantastic district views up the Parramatta River. Style, light and quality features throughout this modern home that's situated high in the sought-after Zen tower and on the doorstep of Wentworth Point's vibrant cafe, dining and transport hub.

- 10th floor position with a stunning elevated outlook
- Expansive views that spread over parklands and skyline
- Floor-to-ceiling walls of glass maximise light throughout
- Bright open design includes an enclosed wintergarden
- Quality modern kitchen with sleek gas fittings and dishwasher
- Good-sized double bedroom and a sleek modern bathroom
- Security basement car space plus lock-up storage cage
- Ducted air-conditioning, video intercom and lift access

### View

As advertised or by appointment

### Agents

#### Dylan Choe

📞 0416 932 977  
✉ dylanchoe@morton.com.au

#### Akanksha Chaudhari

📞 0447 201 786  
✉ akanksha@morton.com.au

[morton.com.au](https://morton.com.au)



STORAGE  
1.0 x 2.0m

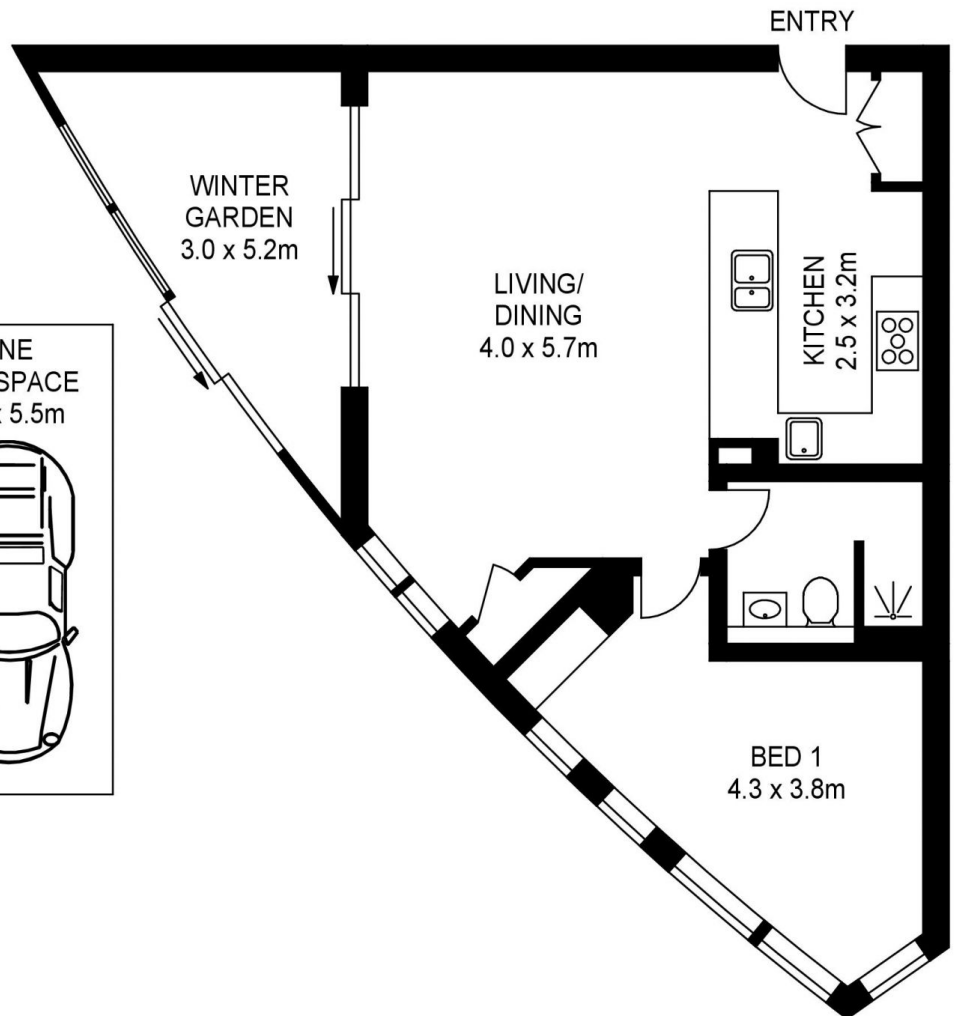
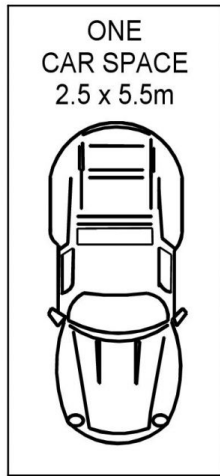

APPROX. INT. AREA : 61 m<sup>2</sup>  
APPROX. EXT. AREA : 26 m<sup>2</sup>  
TOTAL AREA INCLUDING CAR SPACE AND STORAGE : 87 m<sup>2</sup>

## 1010/2 WATERWAYS STREET, WENTWORTH POINT



[www.assetphotographers.com.au](http://www.assetphotographers.com.au)

Please note these measurements are approximate only. The plans is intended as a rough guide for illustrative purpose. It is not warranted or guaranteed to be correct nor it is part of the sale or rental contract