



morton.

Riverwood 908/11A Washington Avenue

🛏 2 🛏 2 🚗 1

Located on level 9 in "Trinity", this fantastic apartment offers a beautiful view overlooking from the big balcony. A brand new lifestyle in a peaceful and master planned community. With easy access to the M5 and only 20kms to the CBD. This huge two-bedroom plus study apartment represents the upper echelon of apartment living.

APARTMENT FEATURES

- Apartment size 100sqm
- Reverse cycle air conditioning
- Stainless steel kitchen appliances
- Stone bench tops, mirror splash backs
- Wool carpets, efficient LED down lights
- Data/TV points in living and main bedroom
- Recessed mirrored cabinets in bathroom
- Separate study area & internal laundry
- Large open plan living/dining, opens onto balcony
- Double bedroom including built-in wardrobe
- Big study
- Secure car space in building, lift with intercom

View

As advertised or by appointment

Agent

Lisa Xi

📞 0401 311 667

✉ lisa@morton.com.au

morton.com.au



TRINITY

**APARTMENT 908
LOT 66
2 BED + STUDY**

Internal	84sqm
External	14sqm
Total	98sqm

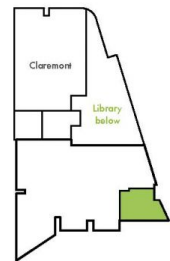

1300 111 088
www.washingtonpark.com.au

Proudly developed by
PAYCE

Disclaimer: This floor plan has been prepared for marketing purposes only. All descriptions, dimensions, depictions and other details in this floor plan may not be to scale and may vary from the property as built. Your attention is drawn to the special conditions of the contract for sale of land. No third party has any authority to make or give any representation or warranty in relation to the property unless the representation or warranty is confirmed by Payce Communities No. 4 Pty Limited and included in the contract for sale of land. [Rev L_12.11.15]

**We are
Washington Park.**