



morton.

St Marys 66 Sydney Street

3 1 12

So many options for the home buyer, investor or developer as this big home sits on a large 942m2 block with a zoning of R3. The home needs some cosmetic work but has plenty of potential for the whole family.

- Massive 18m x 7.5m workshop ideal for the car/truck enthusiast
- Plenty of side access to backyard
- Three bedrooms plus study
- Formal lounge and dining
- Large rumpus/games room
- R3 zoning - Development potential (STCA)

View

As advertised or by appointment

Agents

Sarah Fowell

☎ sarah@morton.com.au

Ian Ahearn

☎ 0457 483 610
✉ ian.ahearn@morton.com.au

morton.com.au

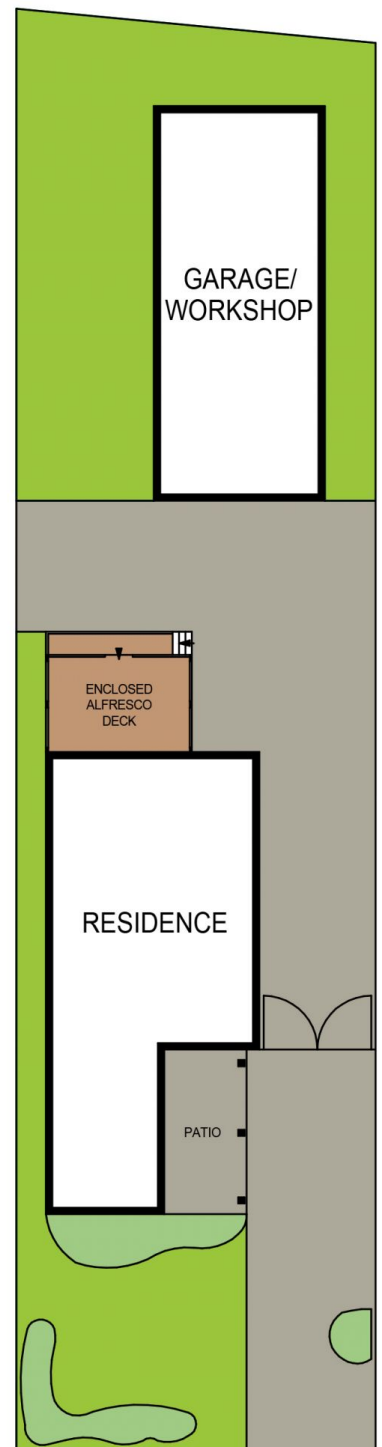
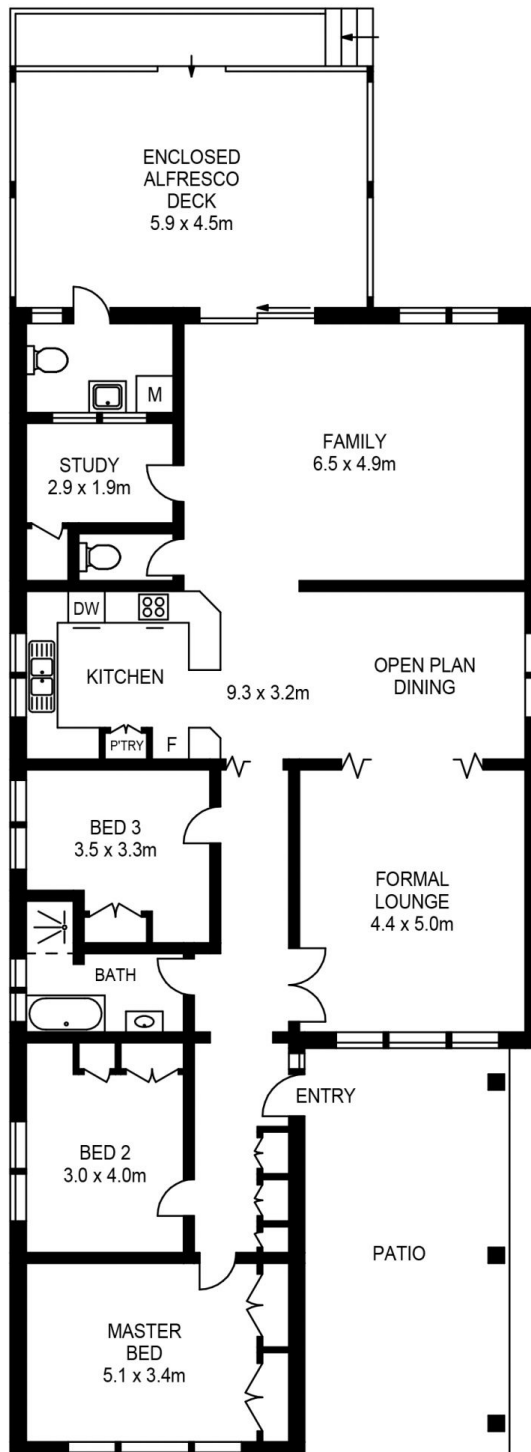
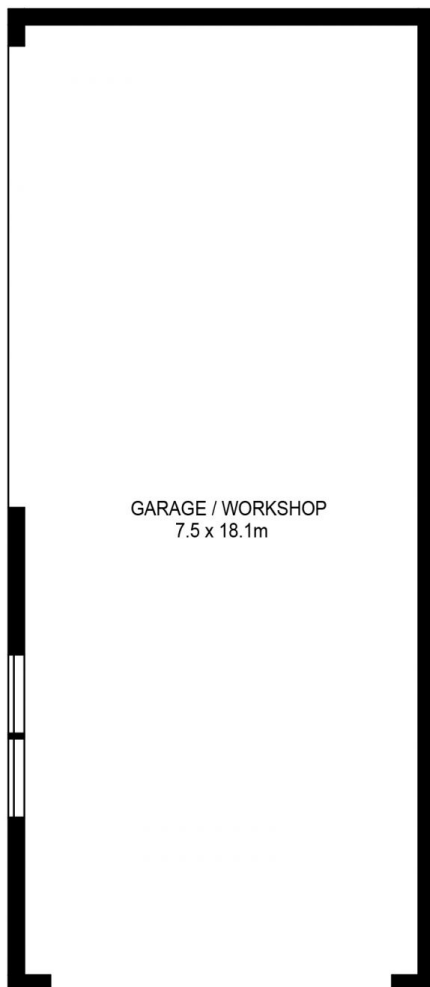

APPROX. INT. AREA : 303 m²
APPROX. EXT. AREA : 67 m²
TOTAL AREA INCLUDING CAR SPACE AND STORAGE : 370 m²

66 SYDNEY STREET, ST MARYS



www.assetphotographers.com.au

Please note these measurements are approximate only. The plans are intended as a rough guide for illustrative purpose. It is not warranted or guaranteed to be correct nor is it part of the sale or rental contract

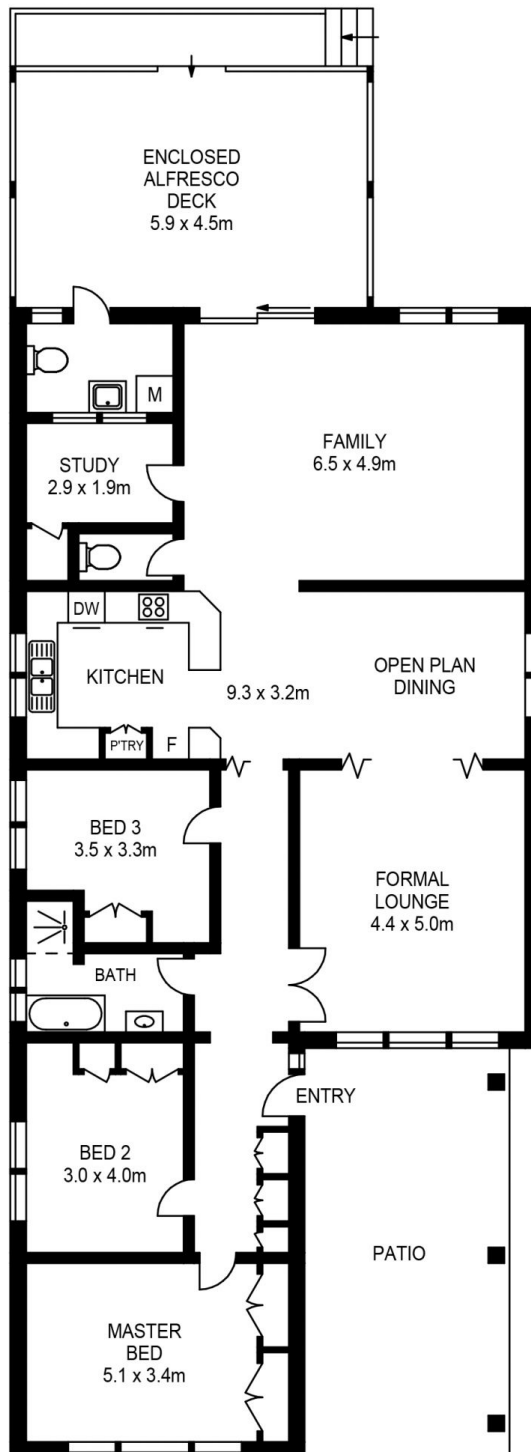
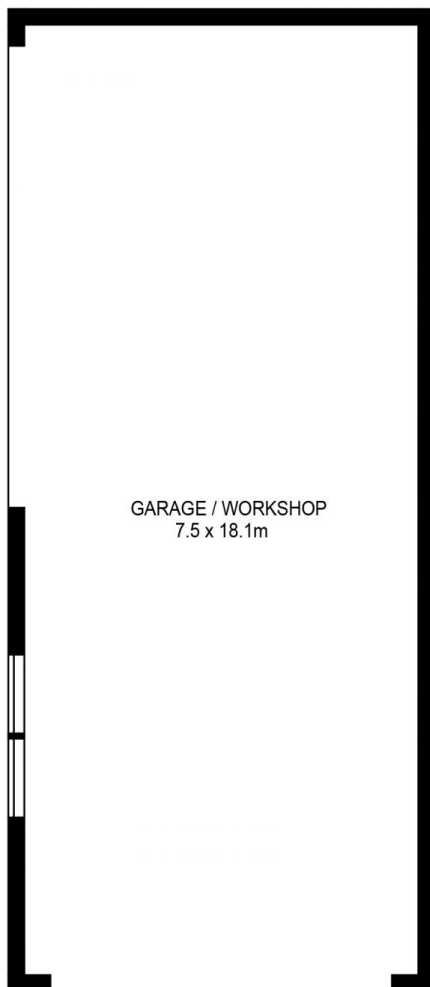

APPROX. INT. AREA : 303 m²
APPROX. EXT. AREA : 67 m²
TOTAL AREA INCLUDING CAR SPACE AND STORAGE : 370 m²

66 SYDNEY STREET, ST MARYS



www.assetphotographers.com.au

Please note these measurements are approximate only. The plans are intended as a rough guide for illustrative purpose. It is not warranted or guaranteed to be correct nor is it part of the sale or rental contract