



# morton.

**Zetland** 828/2 Kirby Walk

1 1 1

This one bedroom plus study apartment is located in the sought-after building 'Platinum'. Located in the vibrant Victoria Park precinct, just 3km from the CBD, the Platinum development by Payce is sophisticated urban living at its best. Platinum's five buildings surround a beautifully landscaped 1,930sqm elevated garden incorporating an alfresco dining and barbecue area, intimate pavilions for relaxing and an Asian-inspired bamboo grove.

- Air conditioning throughout
- Modern gas kitchen with stainless steel Miele appliances and dishwasher
- Balcony with gas bayonet, perfect for entertaining
- Partially furnished with TV unit, desk, shelves and integrated fridge
- Modern bathroom with ample storage space
- Internal laundry with dryer
- Close to Green Square Station and East Village shops
- State of the art health club featuring pool, gymnasium and steam rooms

**morton.com.au**

## View

As advertised or by appointment

## Agent

**Kristian Karaspyros**

0436 477 102

kristian.karaspyros@morton.com.au



0 1 2 4



\*High level window

Disclaimer: This floor plan has been prepared for marketing purposes only. All descriptions, dimensions, depictions and other details in this floor plan may not be to scale and may vary to the property as built. No third party has any authority to make or give any representation or warranty in relation to the property. Your attention is drawn to the special conditions of the contract for sale.

Date Issued: 03/12/12 Revision: D

# PLATINUM

BY PAYCE

APARTMENT

## 828

1 BEDROOM

INTERNAL	51 SQM
EXTERNAL	6 SQM
<b>TOTAL</b>	<b>57 SQM</b>

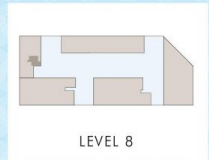

LEVEL 8

PROUDLY DEVELOPED BY:



1300 778 777

platinumbypayce.com.au