



**morton.**

**Narwee** 3/29 Parry Avenue

 2  1  1

Conveniently located in the heart of Narwee, only minutes walk from train station, the bright and spacious two bedroom unit boasting plenty of natural light. Within a short distance to the local schools, cafes and nearby amenities make this living very easy and enjoyable. This unit offers affordable price and great location.

- Two spacious bedrooms, one with built-in
- Combined living and dining
- Good sized kitchen
- Bathroom with bathtub
- Internal laundry
- Timber floor throughout
- Freshly painted
- New plantation shutter
- Secure parking space

#### View

As advertised or by appointment

#### Agents

##### Sarah Fowell



sarah@morton.com.au

##### Calvin Chan



0406 888 028

calvin@morton.com.au

**morton.com.au**

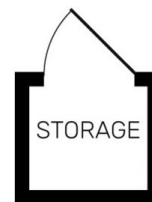
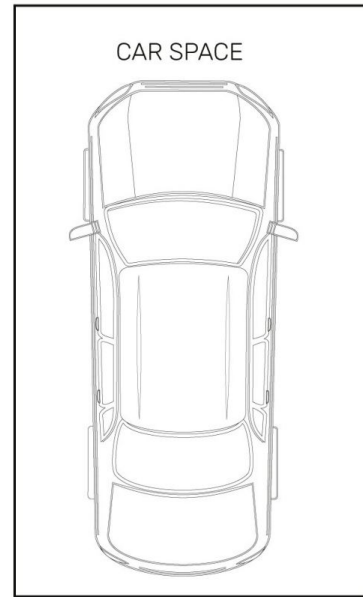
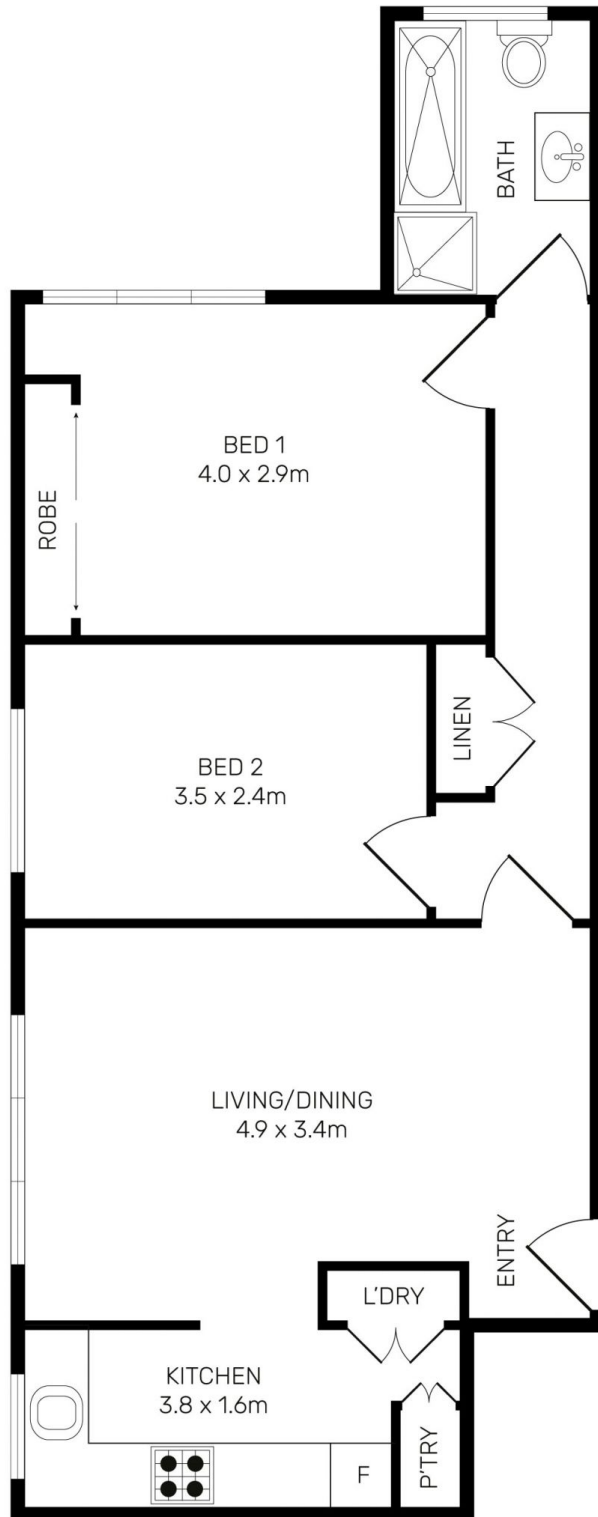

All information contained herein is gathered from all sources we believe to be reliable. However we cannot guarantee its accuracy and interested parties should rely on their own enquiries.



# 3/29 Parry Avenue, Narwee