



morton.

Wentworth Point 1506/11 Wentworth Place

🛏 2 🚿 2 🚗 1

In one of the most sought-after waterfront locations in Wentworth Point, this deluxe two-bedroom residence delivers a superb living experience with panoramas over the water that will take your breath away. It makes a stunning lifestyle property that combines smart stylish interiors, a light-filled layout and many quality design features to deliver an excellent low-maintenance property in a highly regarded security complex.

- Beautiful water views stretch over Homebush Bay to Rhodes
- An enclosed wintergarden makes a great entertainment area
- Light and airy open design that integrates with the wintergarden
- Sleek contemporary kitchen with gas fittings and breakfast bar
- Two generous bedrooms include a main that opens onto the terrace
- A full bath ensuite, guest bathroom and concealed internal laundry
- Security parking plus lock-up storage in the basement car

View

As advertised or by appointment

Agents

Dylan Choe

📞 0416 932 977
✉ dylanchoe@morton.com.au

Vivian Zhang

📞 0447 964 200
✉ vivian@morton.com.au

morton.com.au

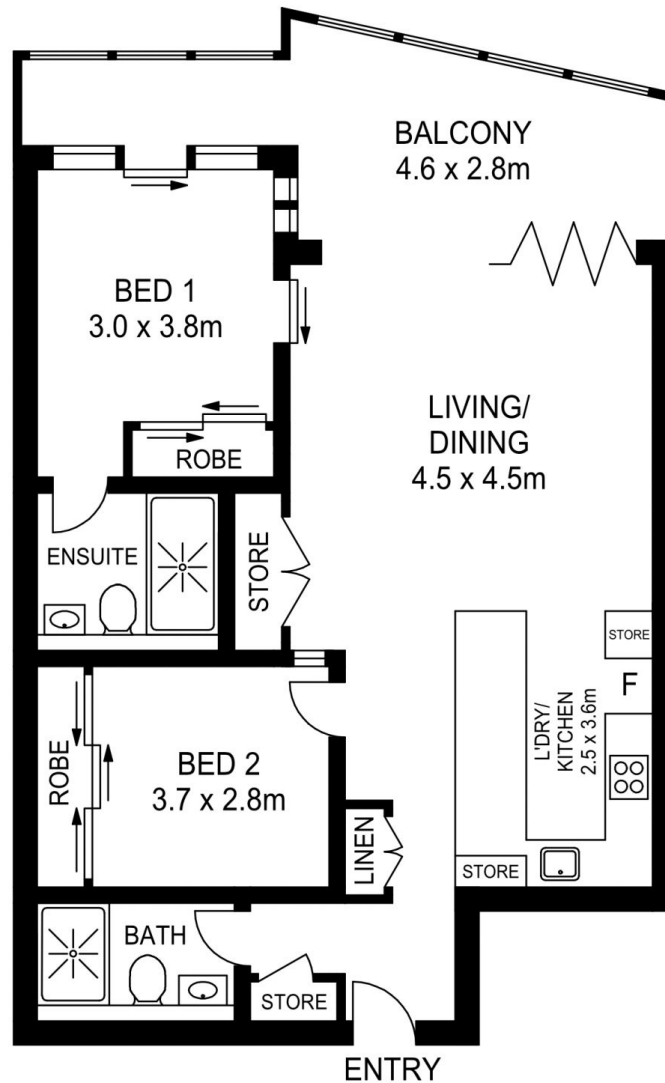
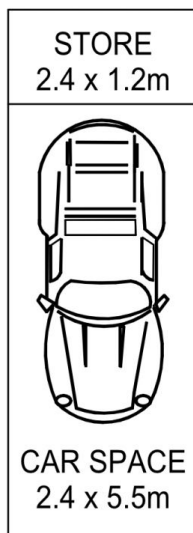

1506/11 WENTWORTH PLACE, WENTWORTH POINT



www.assetphotographers.com.au

Please note these measurements are approximate only. The plans is intended as a rough guide for illustrative purpose. It is not warranted or guaranteed to be correct nor it is part of the sale or rental contract