



morton.

Penrith 405/60 Lord Sheffield Circuit

🛏 2 🚿 2 🚗 1

View

As advertised or by appointment

Agent

David Lipman

📞 0409 663 535

✉ david@morton.com.au

Wildwood Apartments within Sheffield Quarter is located on the north side of Penrith train station situated in the highly sought-after master-planned community Thornton Estate. With uninterrupted park and district views, offering convenient apartment living only metres to Penrith train station, Westfield shopping centre, local parks and quality restaurants and cafes.

- Perfectly positioned on level 4 with oval, canal and Mountain views
- Large island bench with dishwasher and AEG stainless steel appliances
- Split system air con and floorboards in the living room, carpet to bedrooms
- Large double bedrooms with built in robes, master with ensuite
- Generous study room, ideal for working from home
- Blinds in living room and second bedroom, curtains in the master bedroom
- Rooftop BBQ area and seating with panoramic views of the

morton.com.au

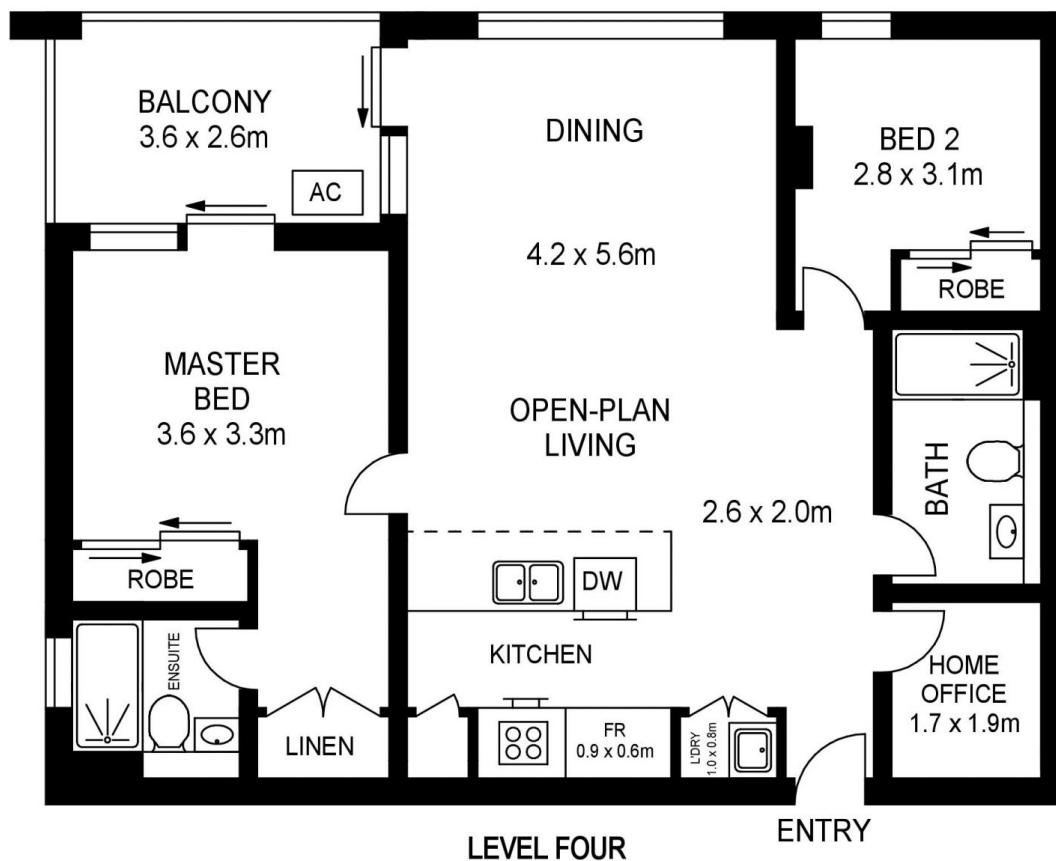
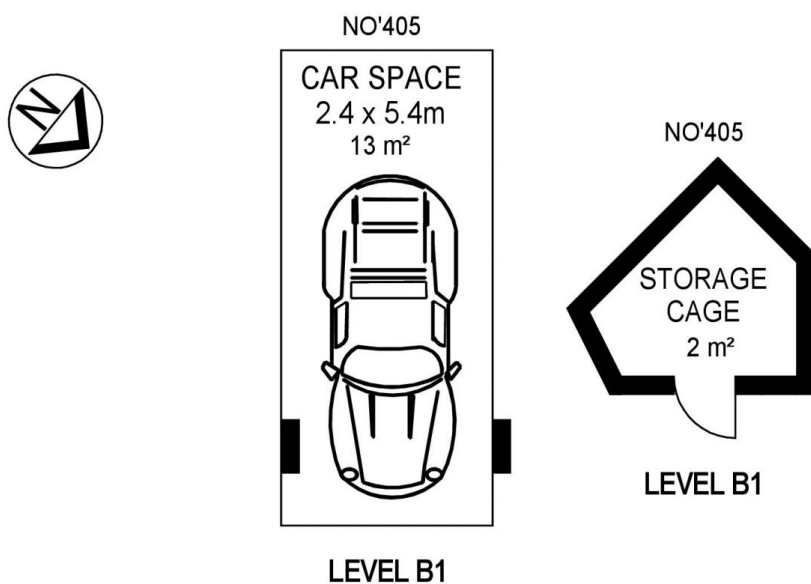

APPROX. INT. AREA : 83 m²
 APPROX. EXT. AREA : 9 m²
 TOTAL AREA INCLUDING CAR SPACE & STORAGE : 108 m²

405/60 LORD SHEFFIELD CIRCUIT, PENRITH



www.assetphotographers.com.au

Please note these measurements are approximate only. The plans is intended as a rough guide for illustrative purpose. It is not warranted or guaranteed to be correct nor it is part of the sale or rental contract