



morton.

Haymarket 1110/178 Thomas Street

 2  2  1

An ultra contemporary designer masterpiece in a central community setting, ideal offering for the professional couple, or those seeking a premier investment. Ideally low maintenance perched on the 11th floor with a pleasant outlook, this is inner city living at its finest.



- Beautifully finished to the most exacting of standards
- Exceptional floor plan with separate bedroom wings
- Well proportioned open plan entertaining, balcony
- Rooftop terrace, indoor and outdoor gyms, low levies
- Double bedrooms, built-ins, master boasts an ensuite
- Customised cabinetry, secure parking, tiled floors
- Deluxe gas kitchen, central island and storage cage
- From renowned award winning firm WMK Architecture

View



As advertised or by appointment

Agents

Ettiene West

 0410 593 749
 ettiene@morton.com.au

Emma Ryan

 0409 325 440
 emmar@morton.com.au

morton.com.au

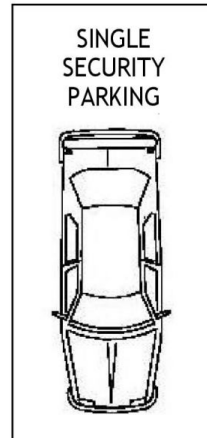
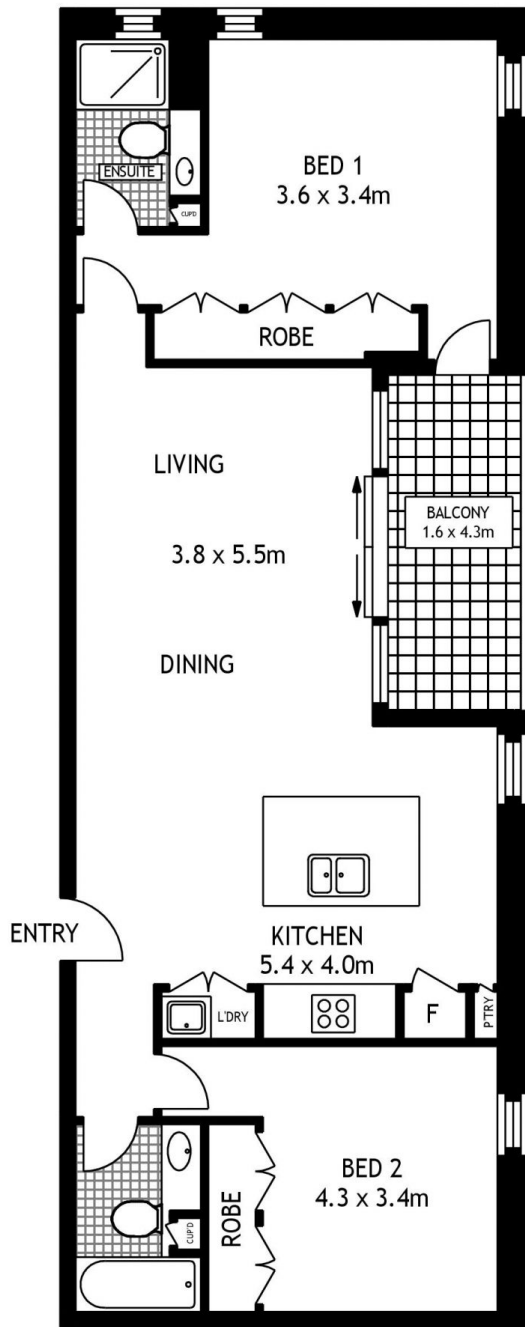

ELEVENTH FLOOR



11.10/178 THOMAS STREET

HAYMARKET

SCAPE Floor Planing Disclaimer: This floor plan is conceptual only. It is provided for illustrative purposes only and should not be relied upon. We make no guarantees to the correctness of this plan. All interested parties should make and rely on their own enquiries in determining the accuracy of the information contained in this floor plan.