



morton.

Riverwood 1004/7 Washington Avenue

 1  1  1

This ultra-modern apartment perfectly expresses the style and flair that are the hallmarks of the master planned 'Washington Park', an address that offers a relaxed community atmosphere. Displaying both fresh modern space and effortless convenience, it offers a sleek contemporary design with easy-care one-bedroom layout and quality appointments.

- Large open design with generous living and dining area
- Wide sheltered terrace capturing a pleasant leafy outlook
- Contemporary stone kitchen and stainless gas appliances
- Large double-sized bedroom plus a separate study area
- Designer bathroom plus a separate internal laundry
- Security car space, air-conditioning and video intercom entry
- A peaceful setting surrounding by parklands and wetlands

View

As advertised or by appointment

Agent

Sarah Fowell



 sarah@morton.com.au

morton.com.au



**APARTMENT 1004
LOT 142
1BED**

Internal	51sqm
External	7sqm
Total	58sqm

COMO

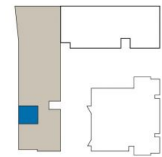

1300 111 088
www.washingtonpark.com.au

Proudly developed by
PAYCE

Disclaimer: This floor plan has been prepared for marketing purposes only. All descriptions, dimensions, depictions and other details in this floor plan may not be to scale and may vary from the property as built. Your attention is drawn to the special conditions of the contract for sale of land. No third party has any authority to make or give any representation or warranty in relation to the property unless the representation or warranty is confirmed by Payce Communities No.1 Pty Limited and included in the contract for sale of land. [Rev A 13.05.13]

**We are
Washington Park.**