



morton.

South Wentworthville 3/51 Chelmsford Road

🛏 2 🚿 1 🚗 1

Situated in a highly sought-after location, this renovated property is the perfect combination of contemporary design complimenting ageless charm. Only a short distance from transport, shops, schools, parks, restaurants, cafes and many more amenities.

- Two spacious bedrooms
- Three built in wardrobes
- Modern LED downlights
- Freshly painted internally
- Free flowing living & dining areas, drenched in natural light
- Spacious kitchen with plenty of storage
- Internal laundry + extra toilet down stairs
- Single garage
- Tidy backyard perfect for entertaining and hosting family & friends
- Split system air condition
- Ultra-convenient location

View

As advertised or by appointment

Agent

Nevena Petrovic

📞 0428 835 910

✉ nevena@morton.com.au

morton.com.au

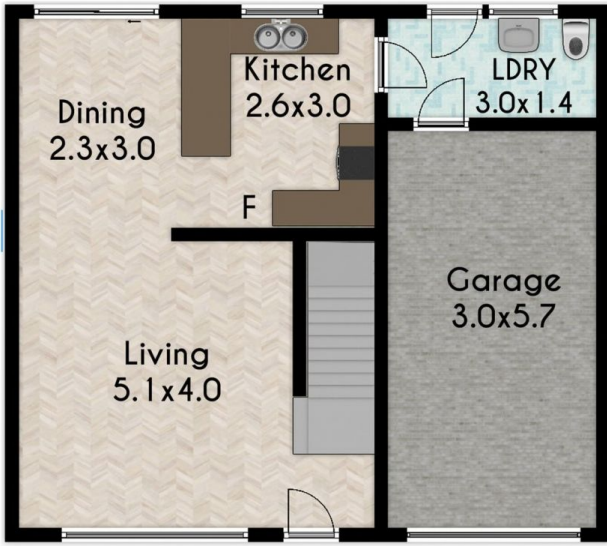

ENTRY

GROUND FLOOR

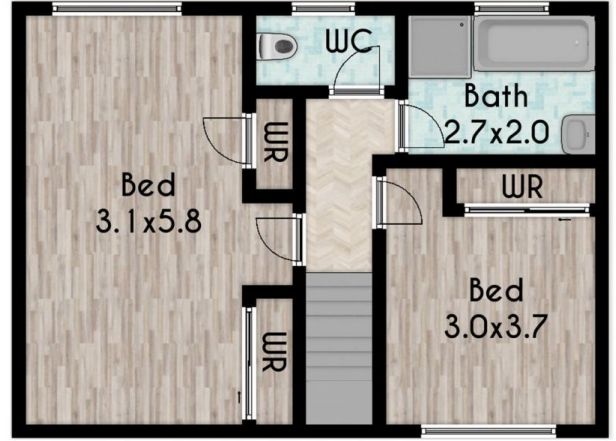

FIRST FLOOR