



# morton.

Wentworth Point 225/1 Burroway Road

🛏 1 🚿 1 🚗 1

Jewel is the iconic gateway that connects the Sydney Harbour to Wentworth Point. Ideally positioned at the northern tip of the peninsular, Jewel is opposite to the ferry wharf, bus stops and rests above the Pierside retail precinct that includes restaurants, health care, beauty and more.

- Entertainers gas kitchen with stone/Corian benchtops, soft closing cupboards
- LED lighting, split system reverse cycle air conditioning
- Open living and dining with timber look ceramic tiles
- Lounge room with gas point and MATV and payTV points
- Wool-blend carpeted bedrooms, mirrored built-in robes
- Internal laundry with dryer, audio intercom with security and lift access
- Bathroom/ensuite with ceramic wall and floor tiles, mirrored vanity cabinet
- Large covered balcony with gas point for BBQ
- Basement secure parking, some with a storage cage
- On-site building manager, common landscaped courtyard

### View

As advertised or by appointment

### Agents

#### Nevena Petrovic

📞 0428 835 910  
✉ nevena@morton.com.au

#### Vivian Zhang

📞 0447 964 200  
✉ vivian@morton.com.au

[morton.com.au](http://morton.com.au)

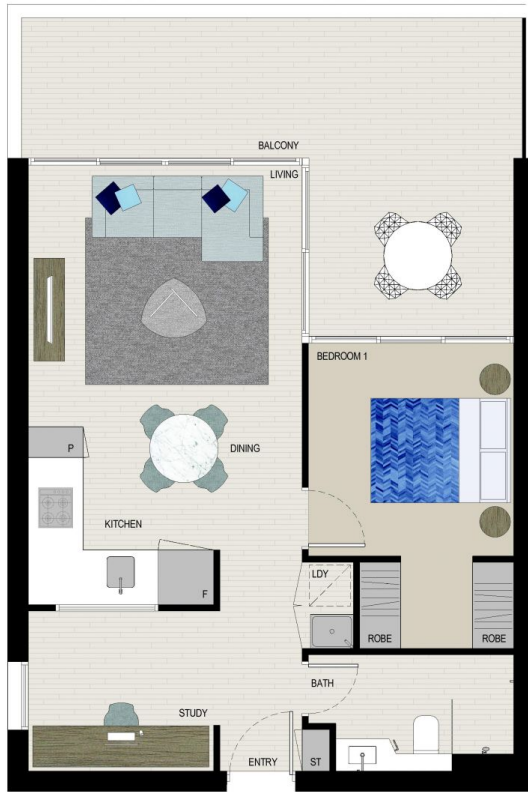

Disclaimer: This floor plan has been prepared for marketing purposes only. All descriptions, dimensions, depictions and other details in this floor plan may not be to scale and may vary from the property as built. Your attention is drawn to the special conditions of the contract for sale of land. No third party has any authority to make or give any representation or warranty in relation to the property unless the representation or warranty is confirmed by Payce Communities Wentworth Point Pty Ltd, SA FWT Development Pty Ltd and included in the contract for sale of land. SCPA Disclaimer: In this disclaimer, Developer means Payce Communities Wentworth Point Pty Ltd, ACN 604 420 744 and SA FWT Development Pty Ltd, ACN 164 381 145. Development means the retail and residential development at Burroway Road Wentworth Point known as Jewel. SCPA means (Spdney Olympic Park Authority, a statutory body constituted under the Spdney Olympic Park Authority Act 2002 (NSW)). The Developer is responsible for all matters in connection with undertaking and completing all of the works required to be performed or carried out to complete the Development and SCPA has no responsibility or involvement in those matters.

JOINTLY DEVELOPED BY



SALES BY



(Rev C\_01/06/15 )



# JEWEL

WENTWORTH POINT

## APARTMENT 225

LOT 73  
1BED + STUDY

Internal	54 sqm
External	22 sqm
<b>Total</b>	<b>76 sqm</b>

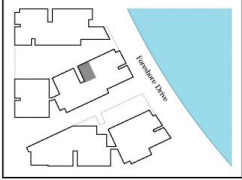

LEVEL 2

**JEWEL DISPLAY CENTRE**  
1 Burroway Road, Wentworth Point 2127

◆ 1300 888 778 ◆ [jewelresidences.com.au](http://jewelresidences.com.au)