



morton.

Sydney 57/177-181 Clarence Street

🛏 2 🚗 2 🚗 1

A haven of peace and oozing prestige in a boutique premier building, this exceptional 132 sqm two-bedroom apartment showcases a lifestyle of generous proportions, comfort, and character. This inviting residence presents a lifestyle of comfort and possibility. Remarkably spacious there is ample opportunity to create a truly luxurious modern home in a world class setting. Located in the highly acclaimed 'Broughton House', it is a very rare offering for those seeking a premium Sydney base, long-term city dwelling or savvy investment.

- Open plan spacious lounge and dining area
- High ceilings, picturesque large windows
- Spacious bedrooms and ample storage
- Enclosed balcony ideal for the entertaining lifestyle
- Internal laundry and ducted air conditioning
- Renowned heritage-listed building in Sydney CBD
- Secure parking on title, on site building manager
- Indoor facilities: pool, spa, fully equipped kitchen
- Outdoor facilities: rooftop tennis court, BBQ area
- Predominately owner-occupied building

morton.com.au

View

As advertised or by appointment

Agents

Ettiene West

📞 0410 593 749
✉ ettiene@morton.com.au

Arman Zounuzu

📞 0410 539 793
✉ arman.zounuzu@morton.com.au

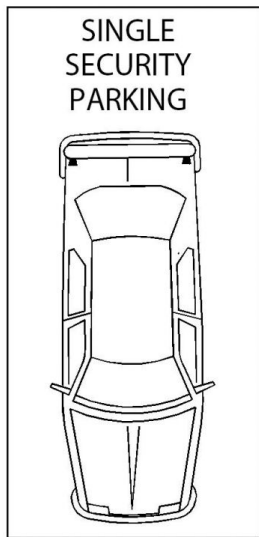

FIFTH FLOOR

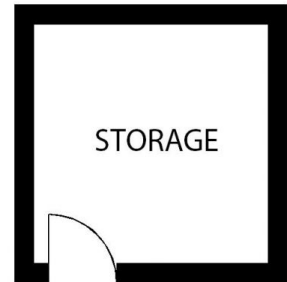

57/181 CLARENCE STREET

SYDNEY

SCAPE Floor Planning Disclaimer: This floor plan is conceptual only. It is provided for illustrative purposes only and should not be relied upon. We make no guarantee as to the correctness of this plan. All interested parties should make and rely on their own enquiries in determining the accuracy of the information contained in this floor plan.