



# morton.

**St Ives** 358/17-19 Memorial Avenue

 2  2  1

Offering all the benefits of townhouse living, this sleek two-storey residence is well proportioned throughout with light-filled interiors and a fresh modern feel. It combines a generous open living space, high-end finishes and a choice of outdoor areas to deliver a stylish home that's quietly tucked away within the popular Lorelea Gardens resort community.

- Light and airy interiors feature an open living and dining area
- Level access to a sunny entertainer's balcony with leafy outlooks
- Two bedrooms include a ground floor main with own courtyard
- Sleek modern kitchen equipped with dishwasher and gas cooktop
- Built-in study nook, two bathrooms and an internal laundry
- Lift access to a security basement car space and visitor parking
- Air-conditioning, video intercom and plenty of built-in storage
- Heated indoor pool, spa, sauna, gym and on-site manager

### View

As advertised or by appointment

### Agent

**Vivian Zhang**

 0447 964 200

 [vivian@morton.com.au](mailto:vivian@morton.com.au)

[morton.com.au](http://morton.com.au)

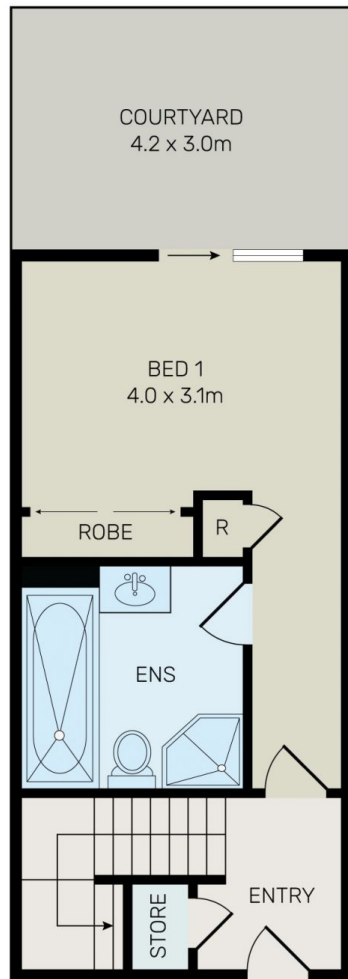
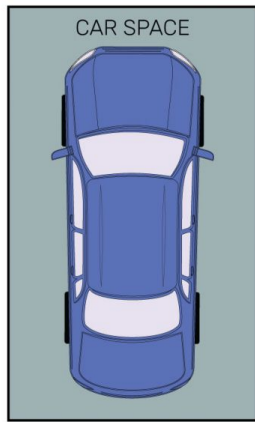

GROUND FLOOR

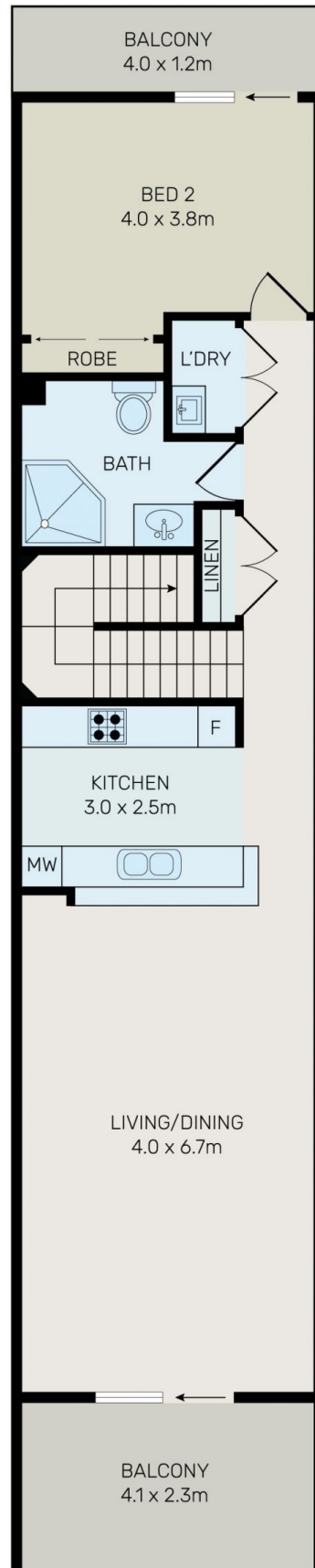

FIRST FLOOR



All information contained herein is gathered from all sources we believe to be reliable. However we cannot guarantee its accuracy and interested parties should rely on their own enquiries.



# 358/17-19 Memorial Avenue, St Ives