



morton.

Wentworth Point 136/27 Bennelong Parkway

 2  2  1

The Waterfront is located moments to Sydney Olympic Park main venues, train station, Bicentennial Park and Millennium Parklands. Located in Mariners' Cove, this is your opportunity to move into this two bedroom apartment only a short stroll from The Promenade and The Piazza.

- Near new carpets, near new blinds, updated balcony deck and recently painted
- Family size kitchen with plenty of cupboard space
- Appliances and gas cooking
- Loads of natural light flowing into the living area
- Good size bedrooms with built-in wardrobe
- Laundry room with clothes dryer
- Large entertainer's balcony with water views
- Single car space

View

As advertised or by appointment

Agent

Nevena Petrovic

 0428 835 910

 nevena@morton.com.au

morton.com.au



DISCLAIMER

NO RESPONSIBILITY TAKEN FOR INFORMATION PROVIDED HEREIN. INTERESTED PARTIES SHOULD RELY ON THEIR OWN ENQUIRIES AND THE CONTRACT FOR SALE. CARPARK AREAS NOT INCLUDED, REFER TO STRATA PLANS FOR ADDITIONAL INFORMATION.

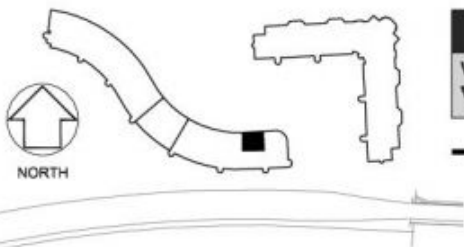

APARTMENT 136

2 BEDROOM

INTERNAL AREA 74 sqm
EXTERNAL AREA 28 sqm
TOTAL AREA 102 sqm

MARINERS COVE

RESIDENTIAL APARTMENTS

27 Bennelong Road
Homebush Bay