



morton.

Pyrmont 410/15 Pirrama Road

🛏 3 🚿 2 🚗 2

Showcasing an exquisite array of luxury finishes and embraced by sensational harbour views, this impeccably renovated residence has been meticulously custom-designed and offers a sensational harbourfront retreat. The bespoke interiors are beautifully detailed with high-end fixtures throughout and finished with inclusions sourced from around the globe. Exceptional craftsmanship has created a home like no other, and at every turn, this extraordinary abode will continue to provide space, style and luxury for generations to come.

- Set within Mirvac's highly sought-after Promontory building
- Beautifully renovated and finished with the finest inclusions
- Soaring 3 metre ceilings ensure an uplifting sense of space
- North-east aspect with a kalidescope of sunrise and sundown
- Floor-to-ceiling walls of glass that highlight the panoramas
- A flowing and light-filled open design for living and dining
- Enormous entertainment terrace with world-class city views
- Integrated master chef's kitchen, Zip hot, chilled and

View

As advertised or by appointment

Agent

James Crow

📞 0410 593 057

✉ james@morton.com.au

morton.com.au

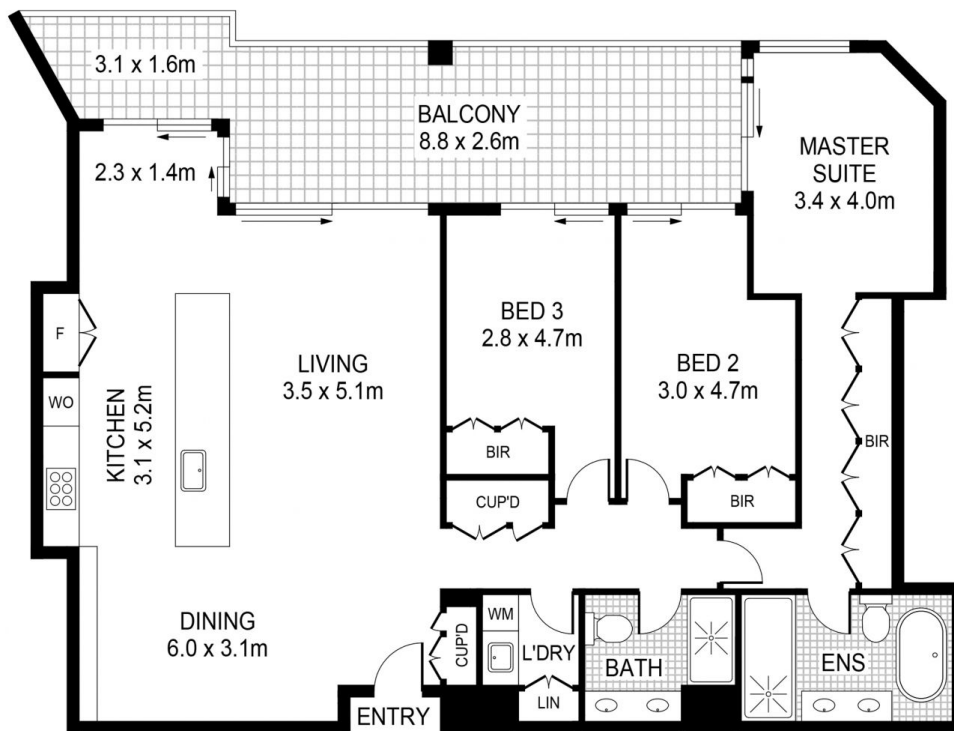

STORAGE
CAGE
2.5 x 1.2m

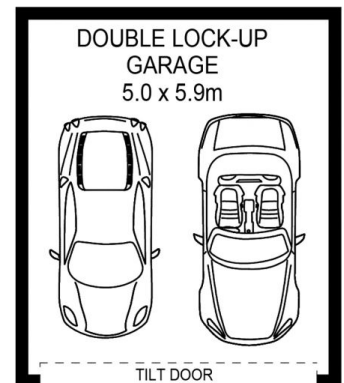

This floor plan including furniture, fixture measurements and dimensions are approximate and for illustrative purposes only.



PYRMONT 410/11-15 Pirrama Road

morton.