



morton.

Melrose Park G02/1A Lemon Tree Avenue

🛏 2 🚿 2 🚗 1

It's rare to find an urban residence that offers such a unique sense of space, privacy and quality. Flowing over a single light-filled level, this ultra-modern apartment has been brilliantly conceived to provide a peaceful sanctuary with a generous-sized courtyard for entertaining. The superbly designed property is fresh, bright and full of style and is quietly set within the prestige The Residences building in the heart of Melrose Park Village.

- Total 141 sqm oversized apartment, 81 sqm internal + 60 sqm courtyard
- Pet-friendly community with access to generous landscaped areas
- Spacious entertainment courtyard that flows off the interior
- A bright North/East aspect and large floor-to-ceiling windows
- Open plan living space is designed to capture good natural light
- Two bedrooms include a main that opens onto the courtyard
- The well-designed gas kitchen includes breakfast bar seating
- A secure basement car space plus lock-up storage cage on

View

As advertised or by appointment

Agents

Dylan Choe

📞 0416 932 977
✉ dylanchoe@morton.com.au

Hintha Mya

📞 0439 649 618
✉ hintha.mya@morton.com.au

morton.com.au

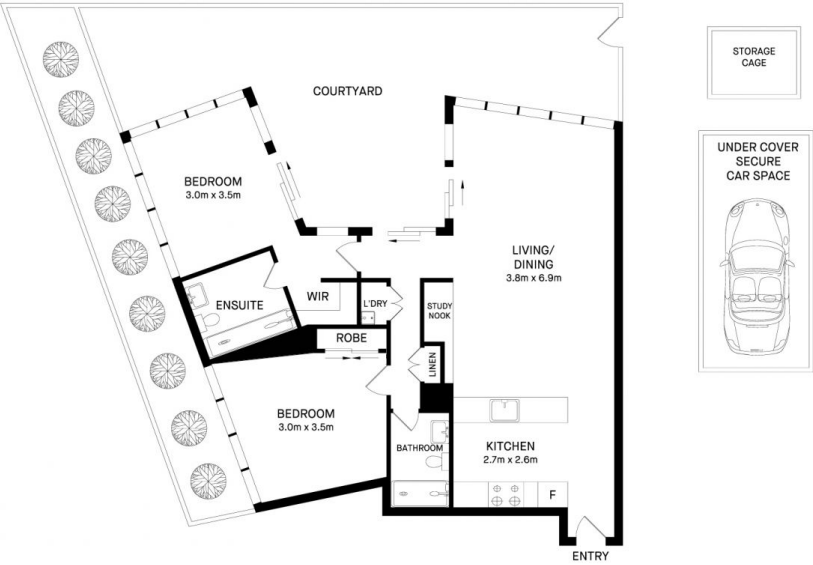

G02/1 Lemon Tree Avenue, Melrose Park



Please note these measurements are approximate only. The plans are intended as a rough guide for illustrative purpose. It is not warranted or guaranteed to be correct nor it is part of the sale or rental contract.

