



morton.

Zetland 310/1 George Julius Avenue

 2  2

The definition of luxurious contemporary living in what is generally considered to be one of the east's most vibrant lifestyle precincts, this flawless garden apartment is the epitome of designer style. A premier opportunity for the couple or investor, it is simply minutes to shops, cafes, restaurants, Eastern beaches and the city.



- An exclusive offering finished to the highest standard
- Impeccably appointed for low maintenance living
- Generous bedrooms fit with built-in wardrobes
- Chic CaesarStone kitchen has stainless gas appliances
- With an inviting open plan lounge and dining space
- Ducted air conditioning
- Internal laundry
- Car Space available for lease within the building at additional cost

View



As advertised or by appointment

Agents

Calvin Chan

 0406 888 028
 calvin@morton.com.au

Jackson Figueiras

 0448 764 345
 jackson@morton.com.au

morton.com.au

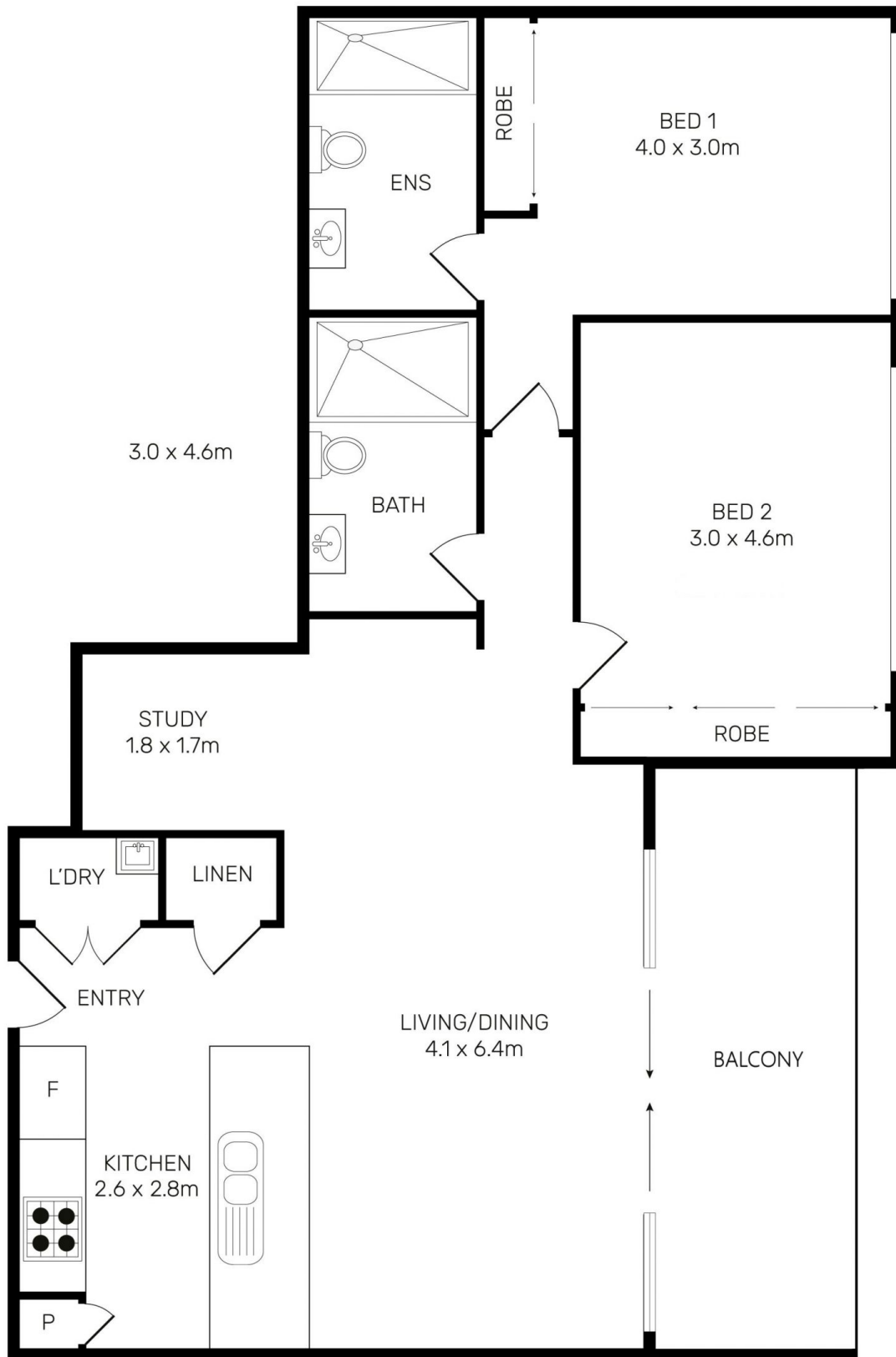

All information contained herein is gathered from all sources we believe to be reliable. However we cannot guarantee its accuracy and interested parties should rely on their own enquiries.



310/1 George Julius Avenue, Zetland