



morton.

Erskineville 630/221 Sydney Park Road

 2  2  1

Featuring three alfresco areas, a secluded study space, and double bedrooms discreetly set on separate floors, the oversized layout brings absolute comfort and privacy for all household members. Crafted for relaxed entertaining all year round, open-plan interiors transition seamlessly to an enclosed terrace with floor-to-ceiling louvers for capturing glorious breezes and sunshine. Perched on the sixth level of the highly regarded Zenix building, indulge in resort-style living with access to impressive facilities including a pool, gym, tennis courts, onsite building manager, and beautifully landscaped gardens. Beyond the home, explore Newtown, St Peters, and Erskineville village within a short stroll.

- Light-filled throughout with open plan lounge and dining areas
- Enclosed east-facing BBQ terrace with leafy district views
- Upstairs master bedroom with separate study and balcony
- Featuring three alfresco areas
- A well-equipped galley kitchen with gas cooktop and dishwasher

morton.com.au

View



As advertised or by appointment

Agents

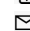
Kristian Karaspyros

-  0436 477 102
-  kristian.karaspyros@morton.com.au

Emma Ryan

-  0409 325 440
-  emmar@morton.com.au

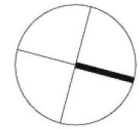

ENTRY UPPER LEVEL

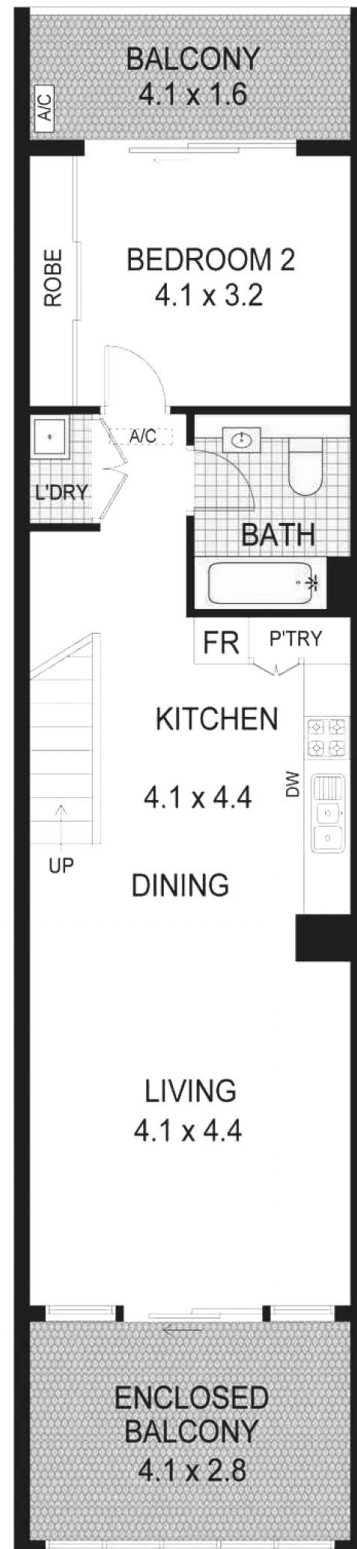

LOWER LEVEL

This floor plan is for marketing purposes and is to be used as a guide only. All efforts have been made to ensure its accuracy although interested parties are urged to rely on their own enquiries.