



# morton.

**Waterloo** 202/92-110 Cope Street

 2  1

This property is the definition of luxurious contemporary living set within close proximity to the vibrant Waterloo city centre. This light filled apartment is the epitome of urban style and short walk to metro station. A premier opportunity for the couple or investor that has all the amenities just a stroll from the front door.



- Exclusive offering finished to the highest standard
- Two large double bedrooms
- Impeccably appointed for low maintenance living
- Chic stone kitchen with stainless gas appliances
- Inviting open plan lounge and dining space
- Air conditioning
- Storage Cage

### View



As advertised or by appointment

### Agents

#### Calvin Chan

 0406 888 028  
 calvin@morton.com.au

#### Jackson Figueiras

 0448 764 345  
 jackson@morton.com.au

[morton.com.au](http://morton.com.au)

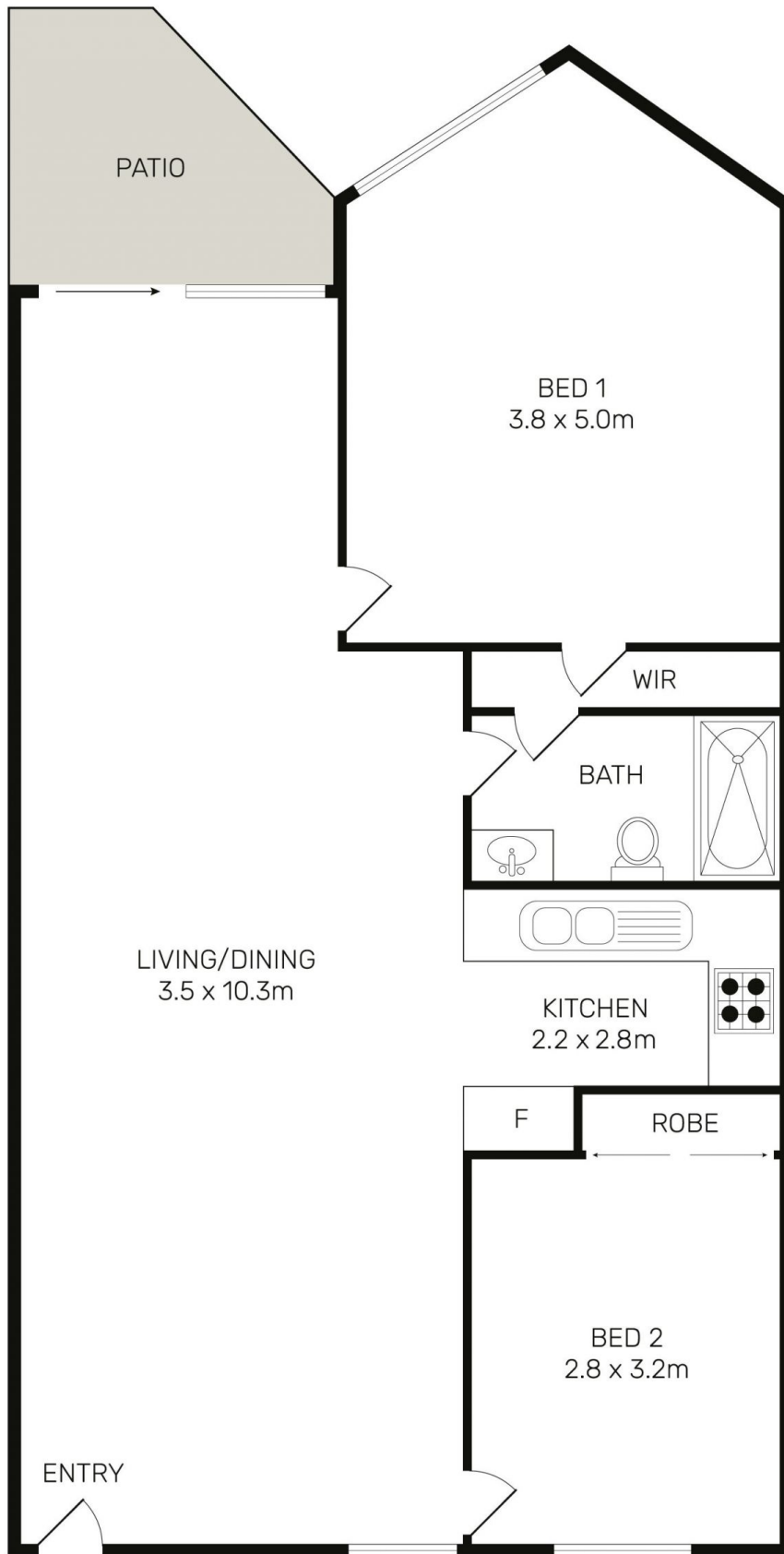

Storage  
Cage



All information contained herein is gathered from all sources we believe to be reliable. However we cannot guarantee its accuracy and interested parties should rely on their own enquiries.

202/92 Cope Street, Waterloo