



morton.

Penrith 16/14 Henry Street

 2  2  1

Discover the perfect blend of comfort and convenience, this exceptional property presents an incredible opportunity to own a cozy haven in the heart of Penrith, just moments away from the CBD.

- Open and airy layout with abundant natural light
- Large North facing balcony with spectacular views of Blue Mountains
- Modern kitchen with sleek appliances and ample storage
- Spacious living and dining area, perfect for entertaining
- Large bedrooms with built in robes, large office/ study room
- Secure basement parking and storage cage

View

As advertised or by appointment

Agent

Morton



 info@morton.com.au

morton.com.au

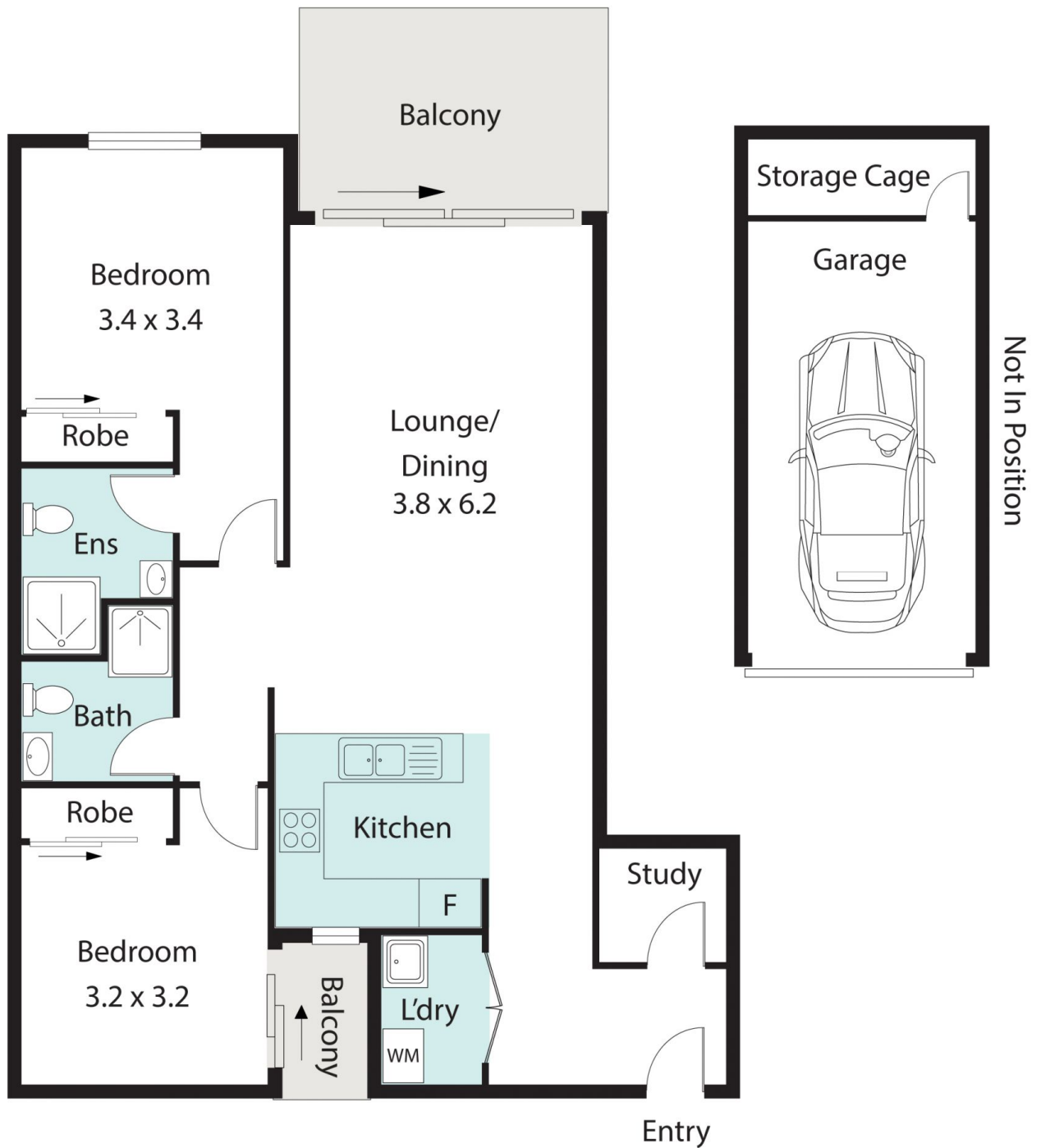

16/14 Henry Street, Penrith, NSW 2750